

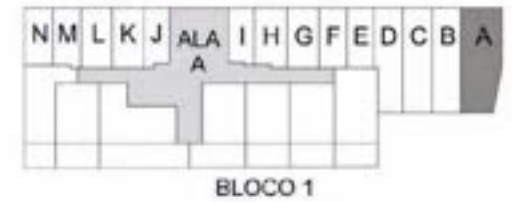

UYARA - BLOCO 1A

LOJA A

Área Privativa - 40,56m²





UYARA - BLOCO 1A
LOJA A - SUGESTÃO DECORAÇÃO ENOTECA
Área Privativa - 40,56m²

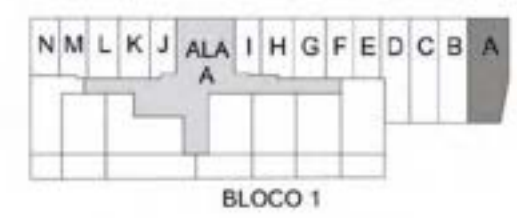

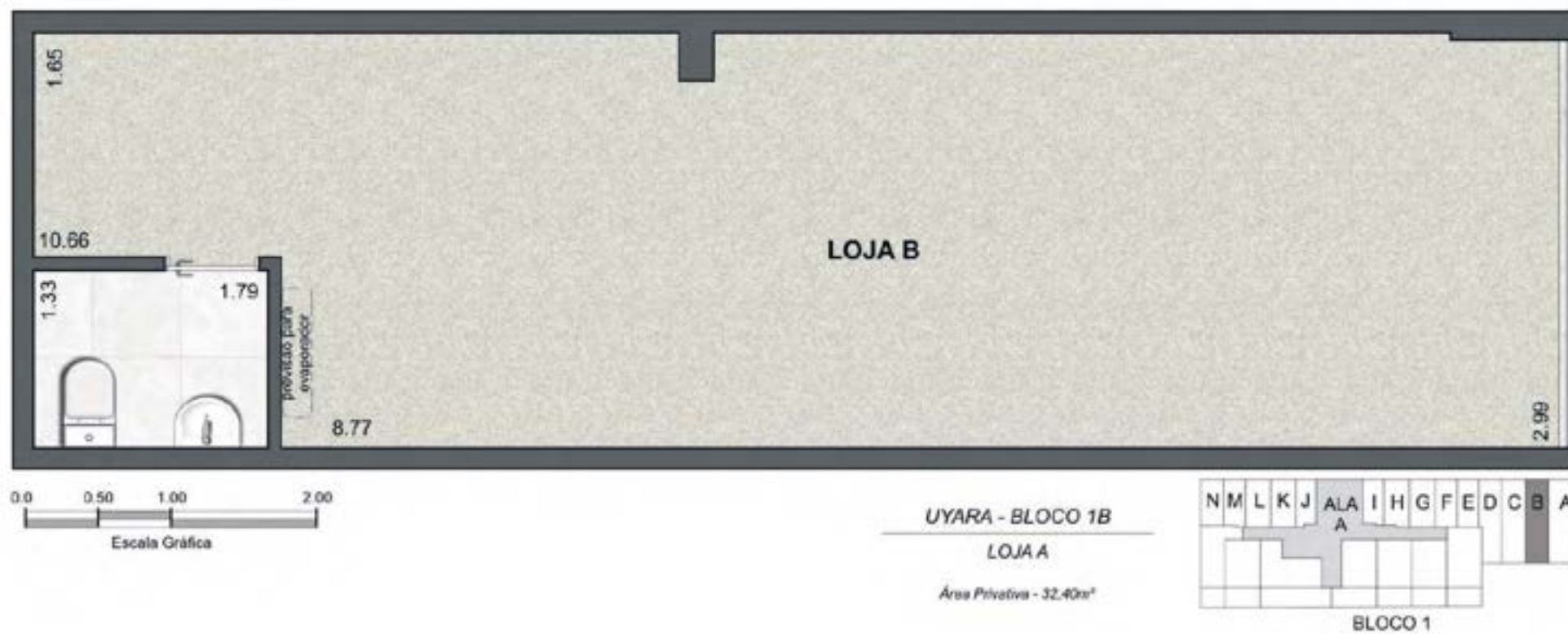

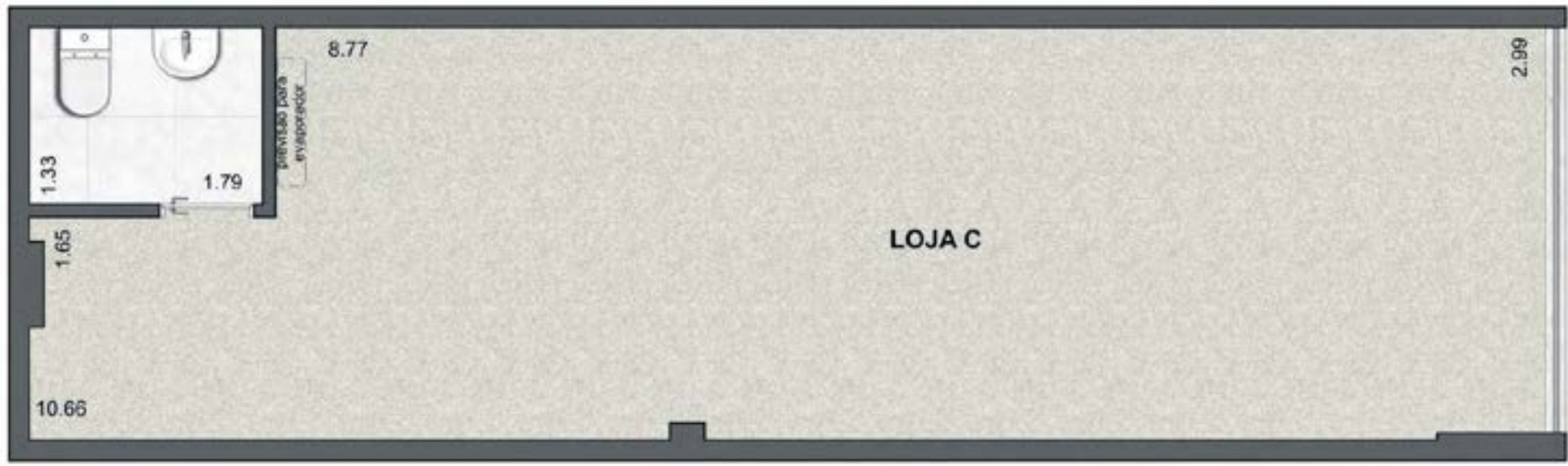

UYARA - BLOCO 1A
LOJA C
Área Privativa - 32,40m²

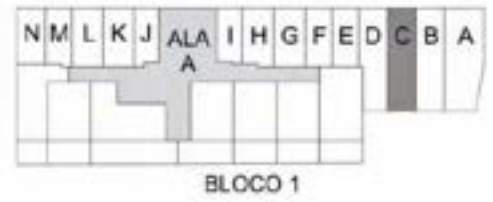

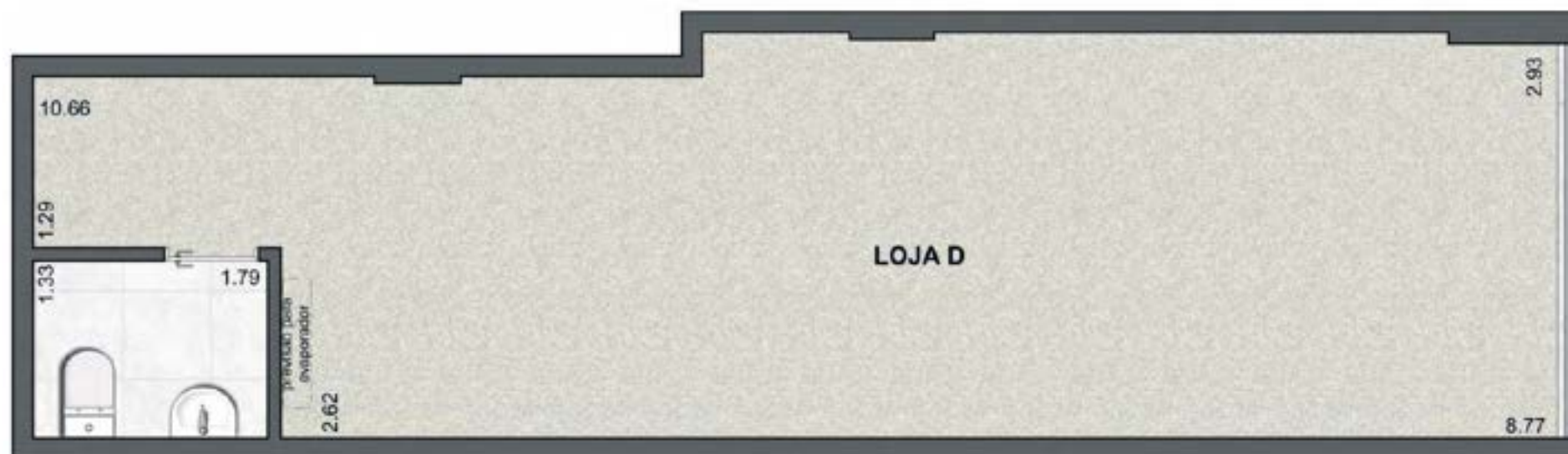

UYARA - BLOCO 1A

LOJA D

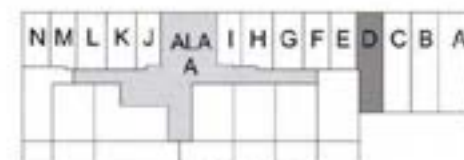
Área Privativa - 31,01m²

BLOCO 1

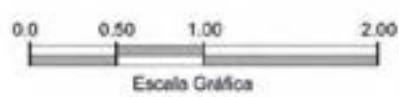

UYARA - BLOCO 1A
LOJA D - SUGESTÃO DECORAÇÃO PET SHOP
Área Privativa - 31,01m²

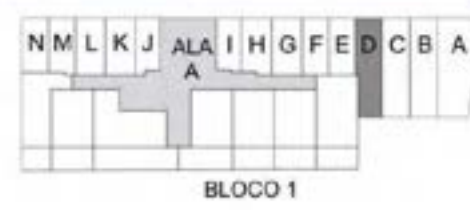

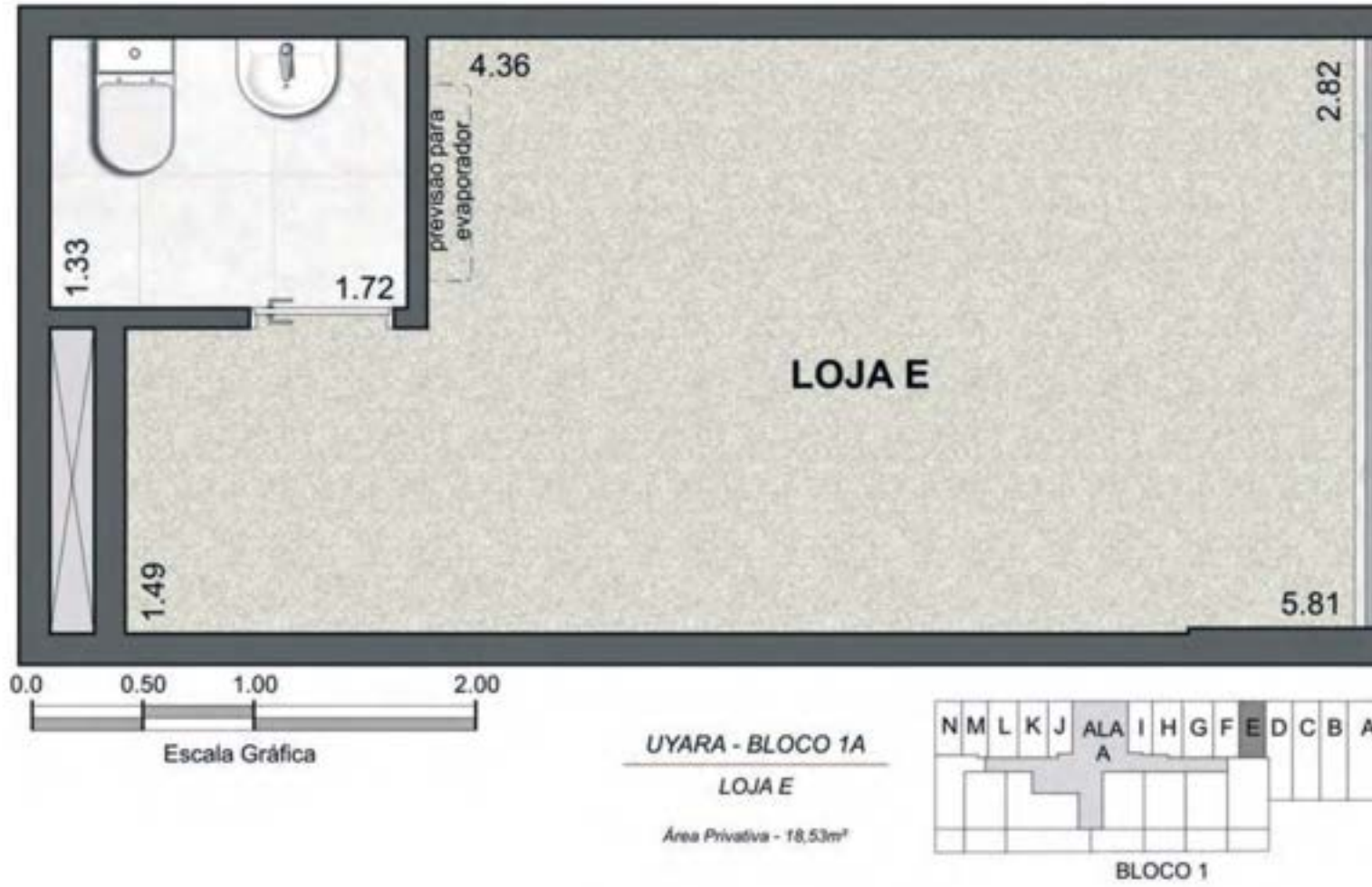



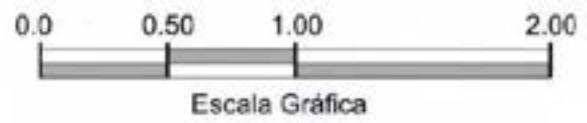
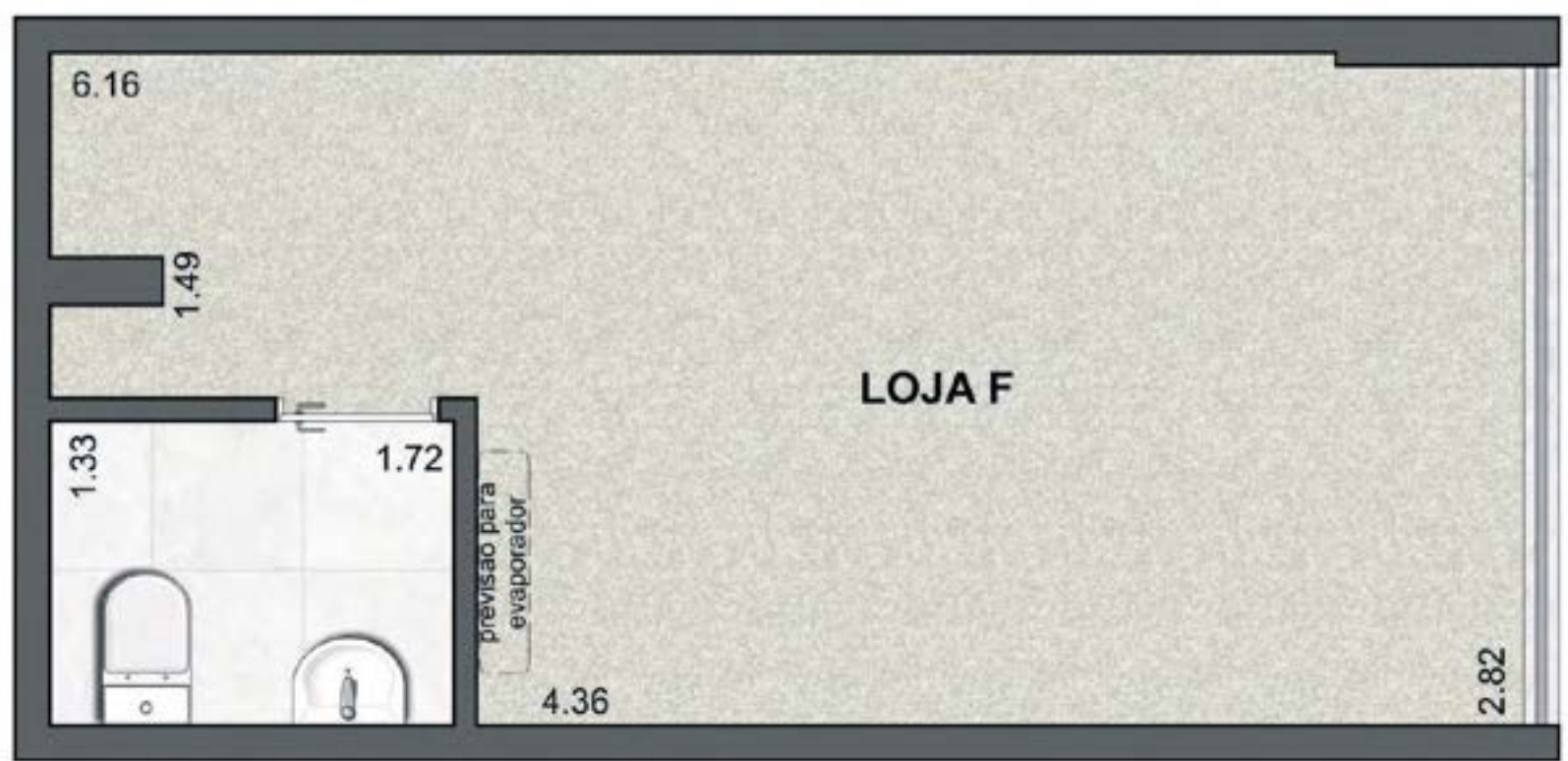

UYARA - BLOCO 1A
LOJA F
Área Privativa - 18,35m²

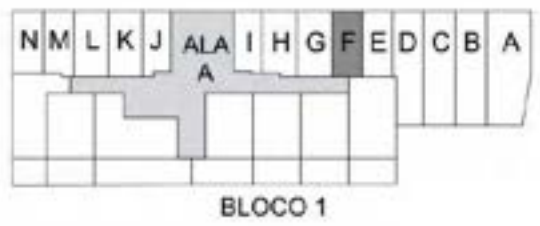

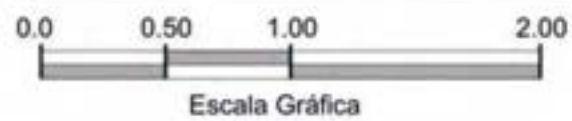
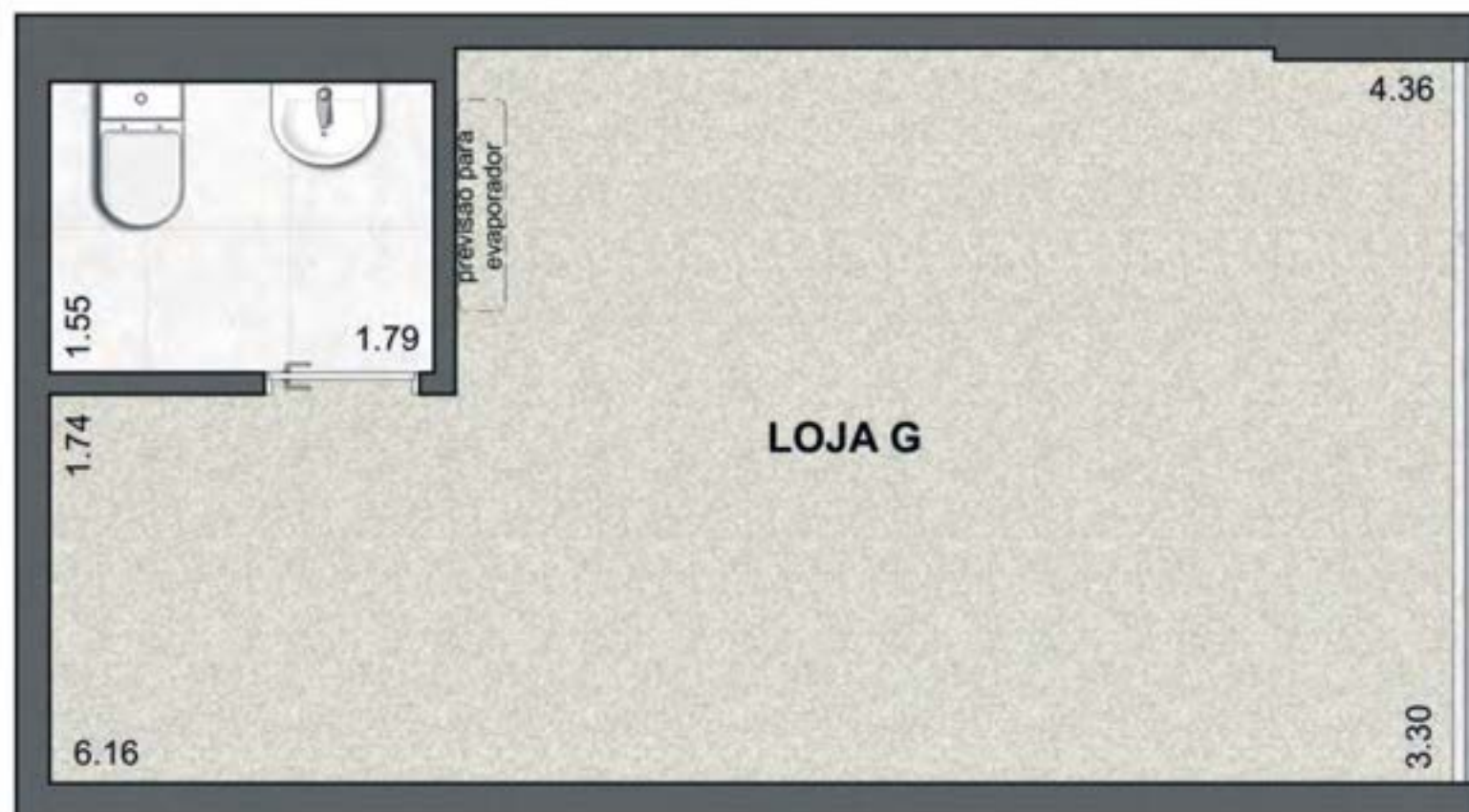

UYARA - BLOCO 1A

LOJA G

Área Privativa - 18,44m²

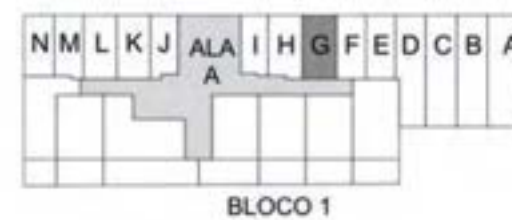

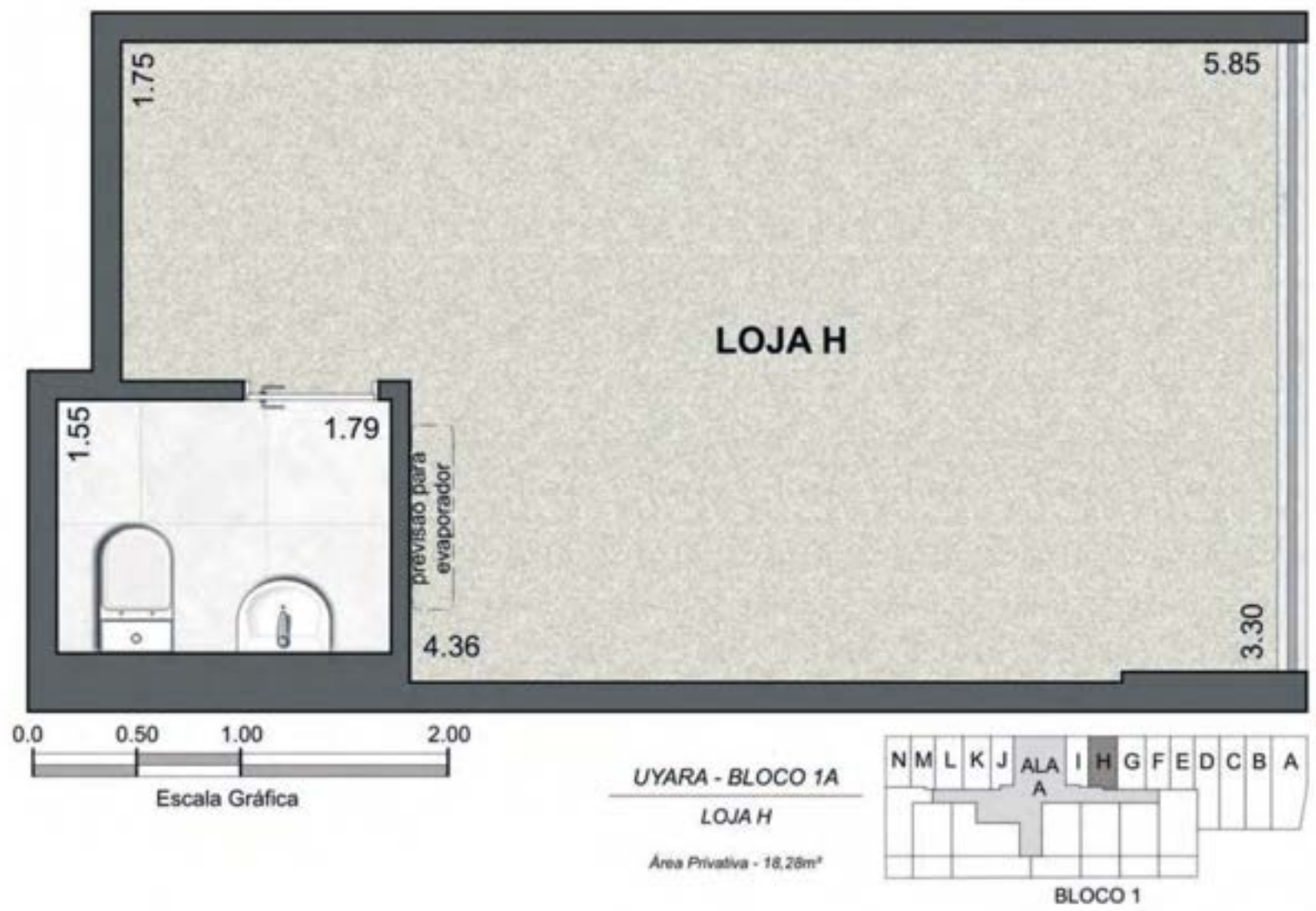

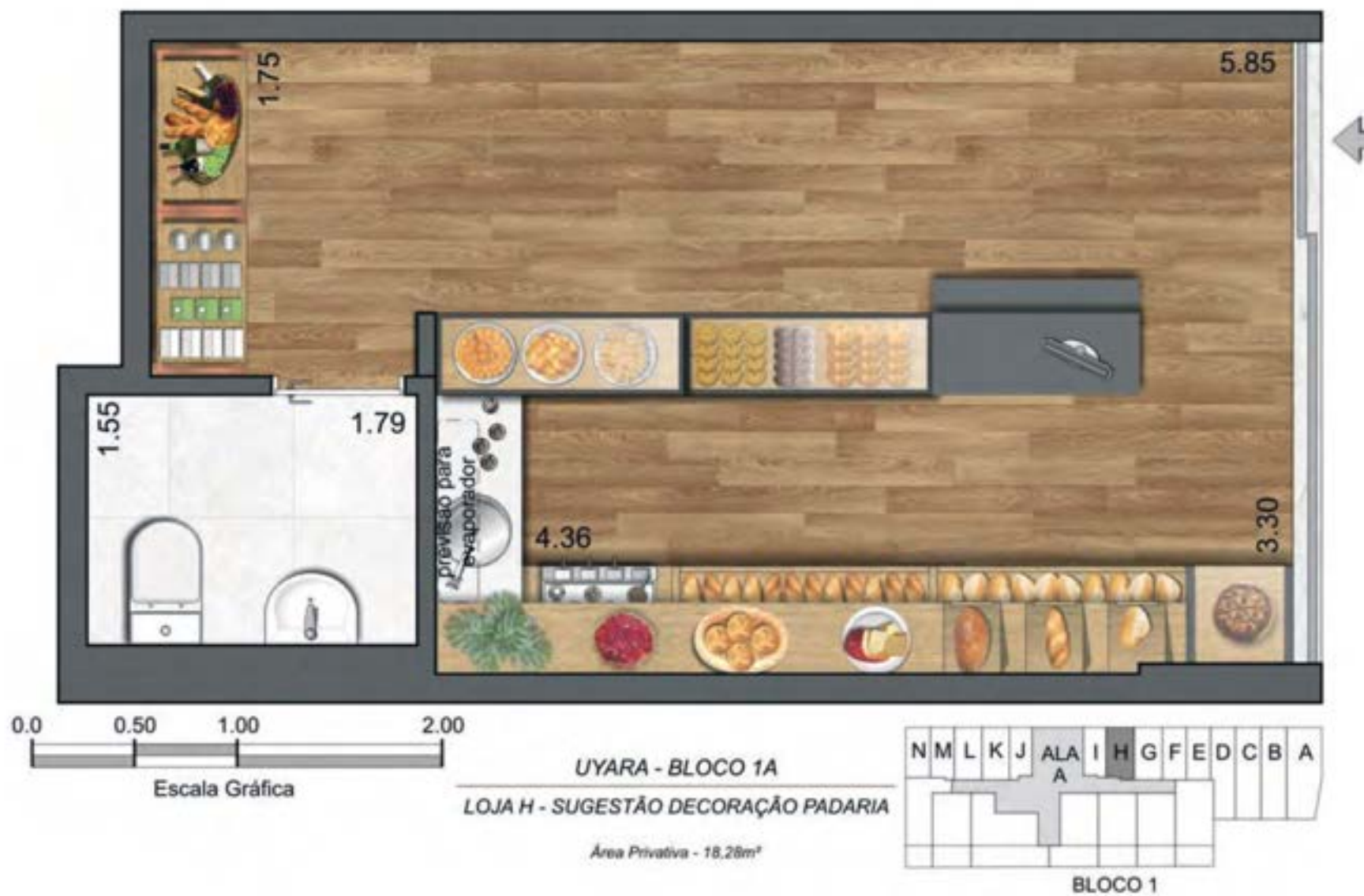

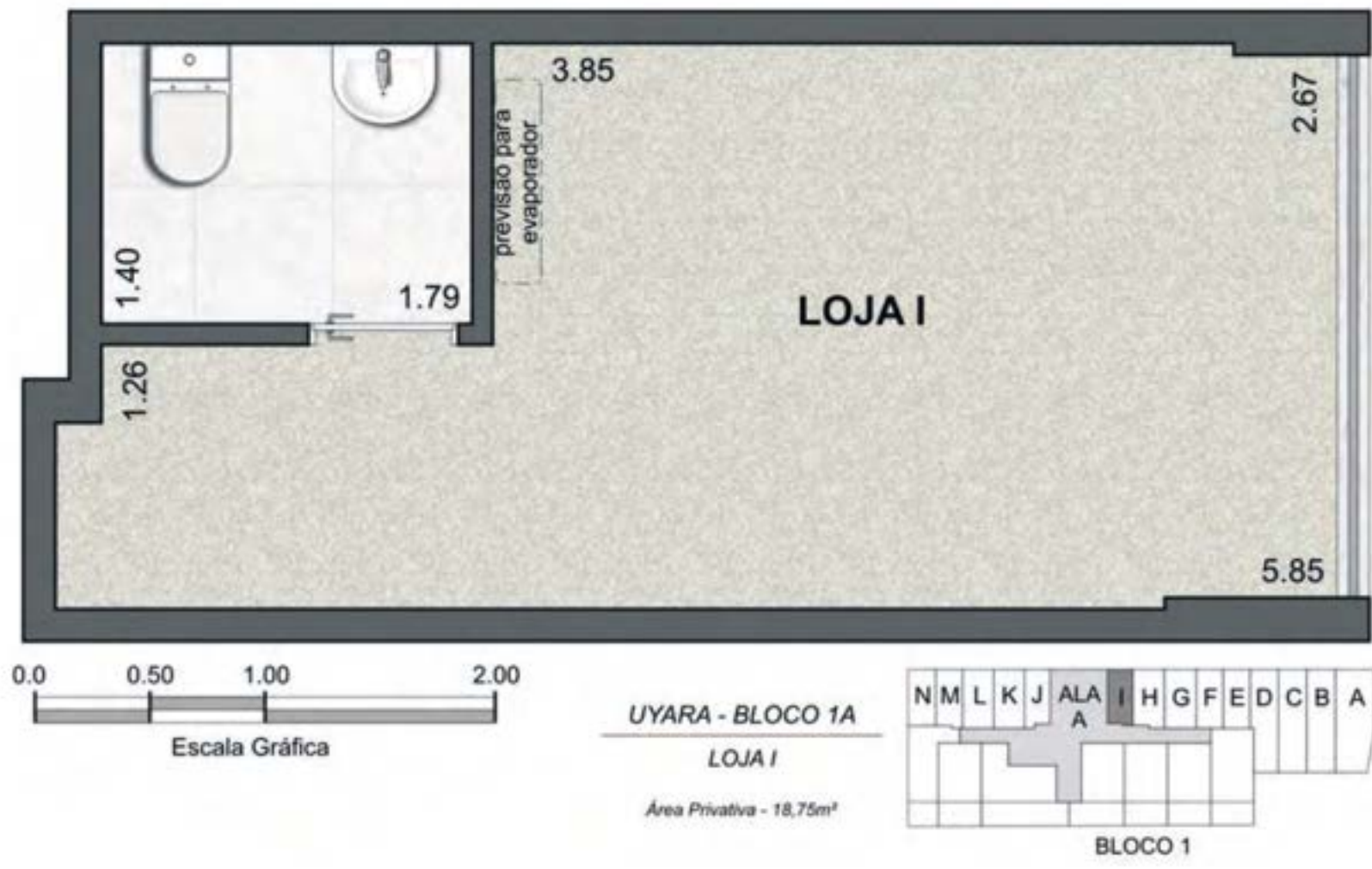

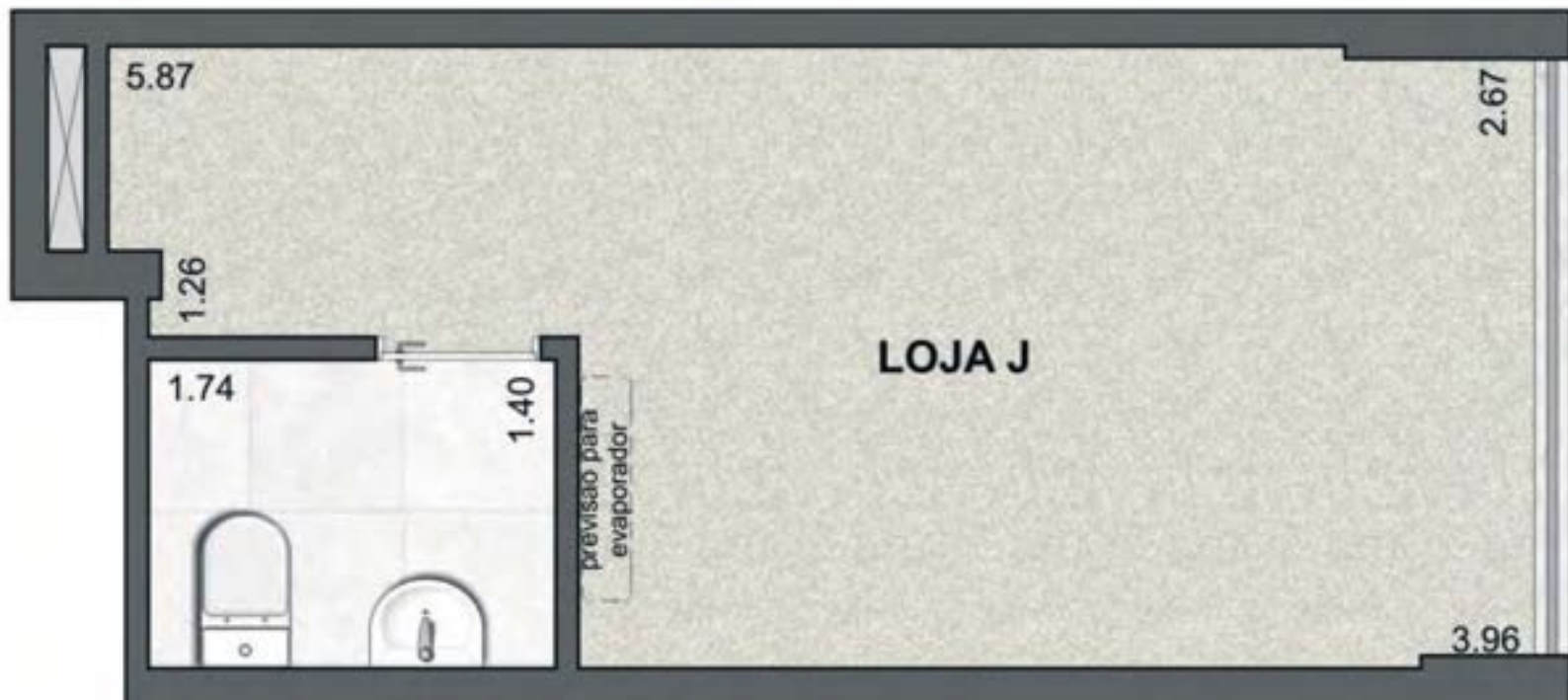

UYARA - BLOCO 1A
LOJA J
Área Privativa - 18,75m²

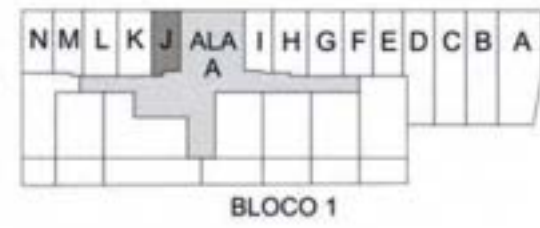

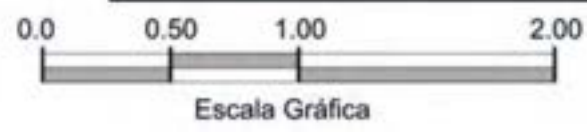

UYARA - BLOCO 1A
 LOJA J - SUGESTÃO DECORAÇÃO
 LOJA AÇAÍ
 Área Privativa - 18,75m²

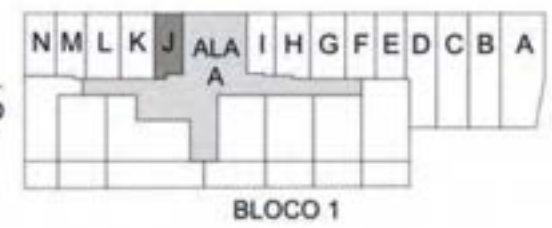

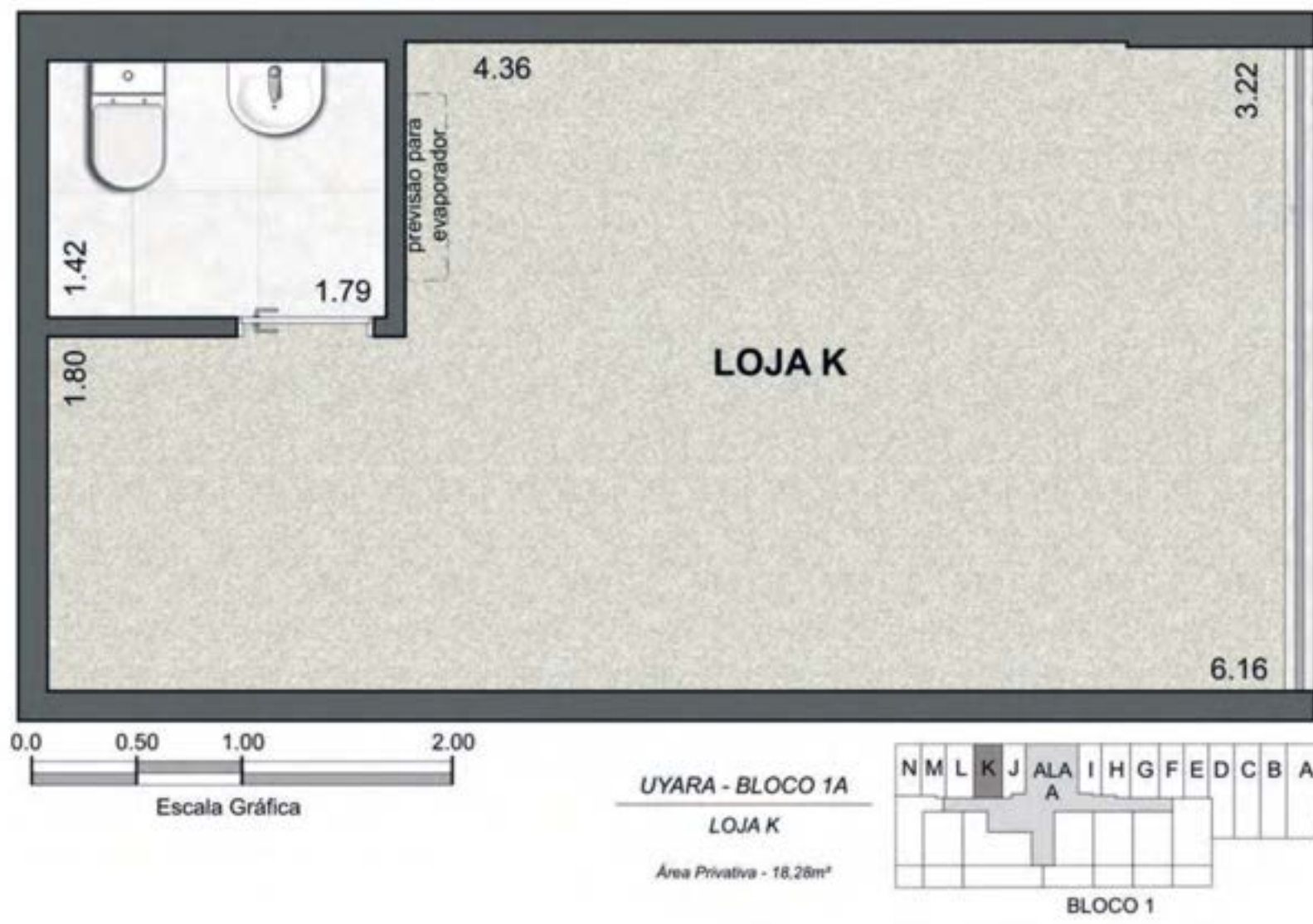

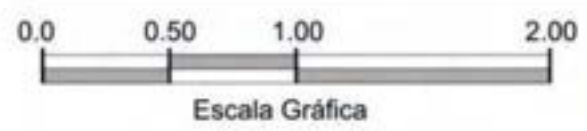
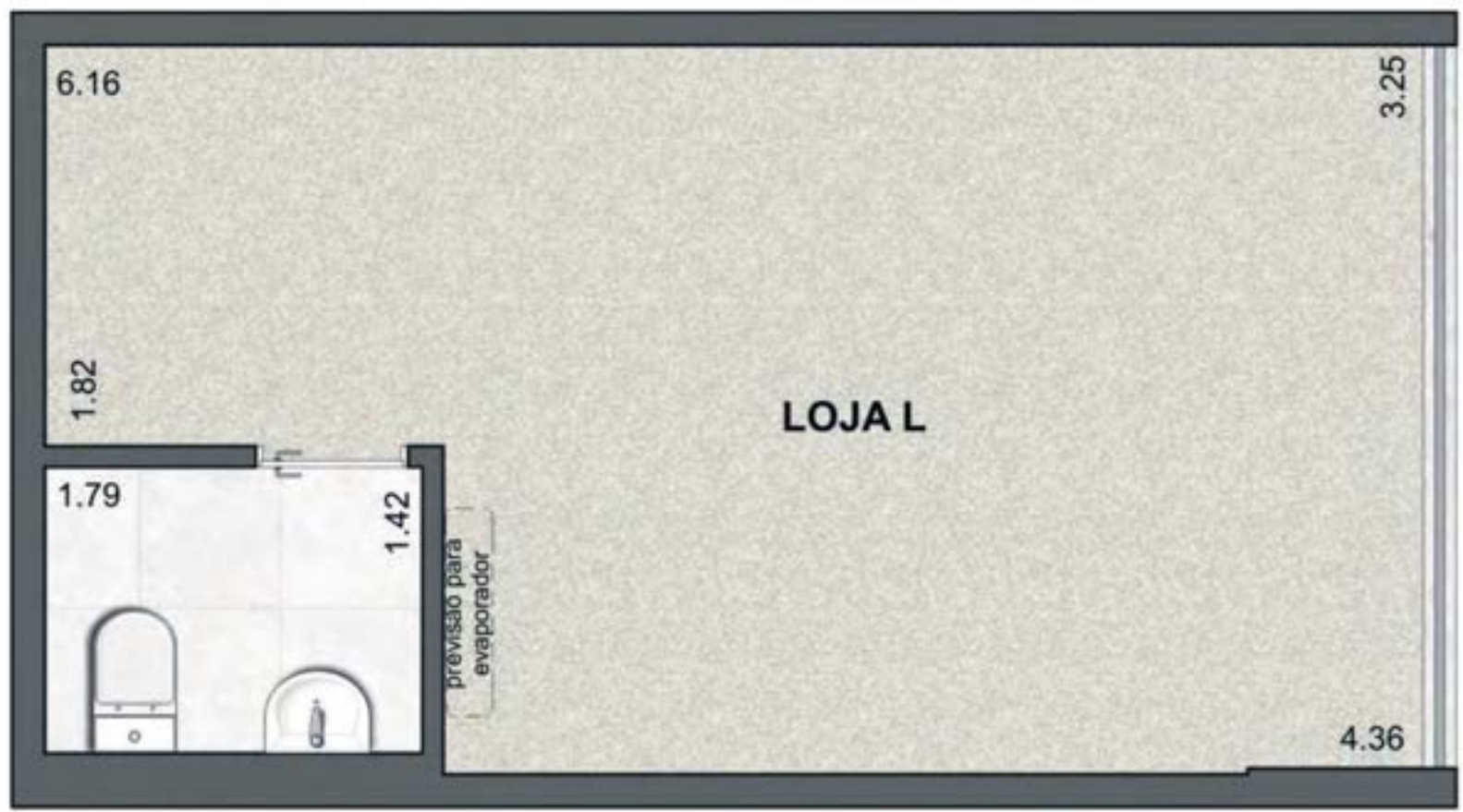

UYARA - BLOCO 1A
LOJA L
Área Privativa - 18,75m²

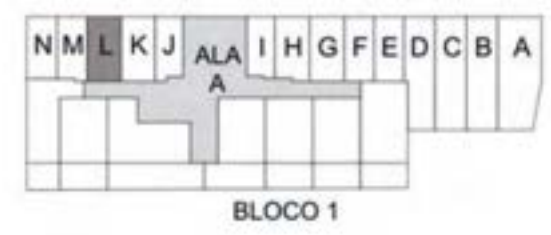

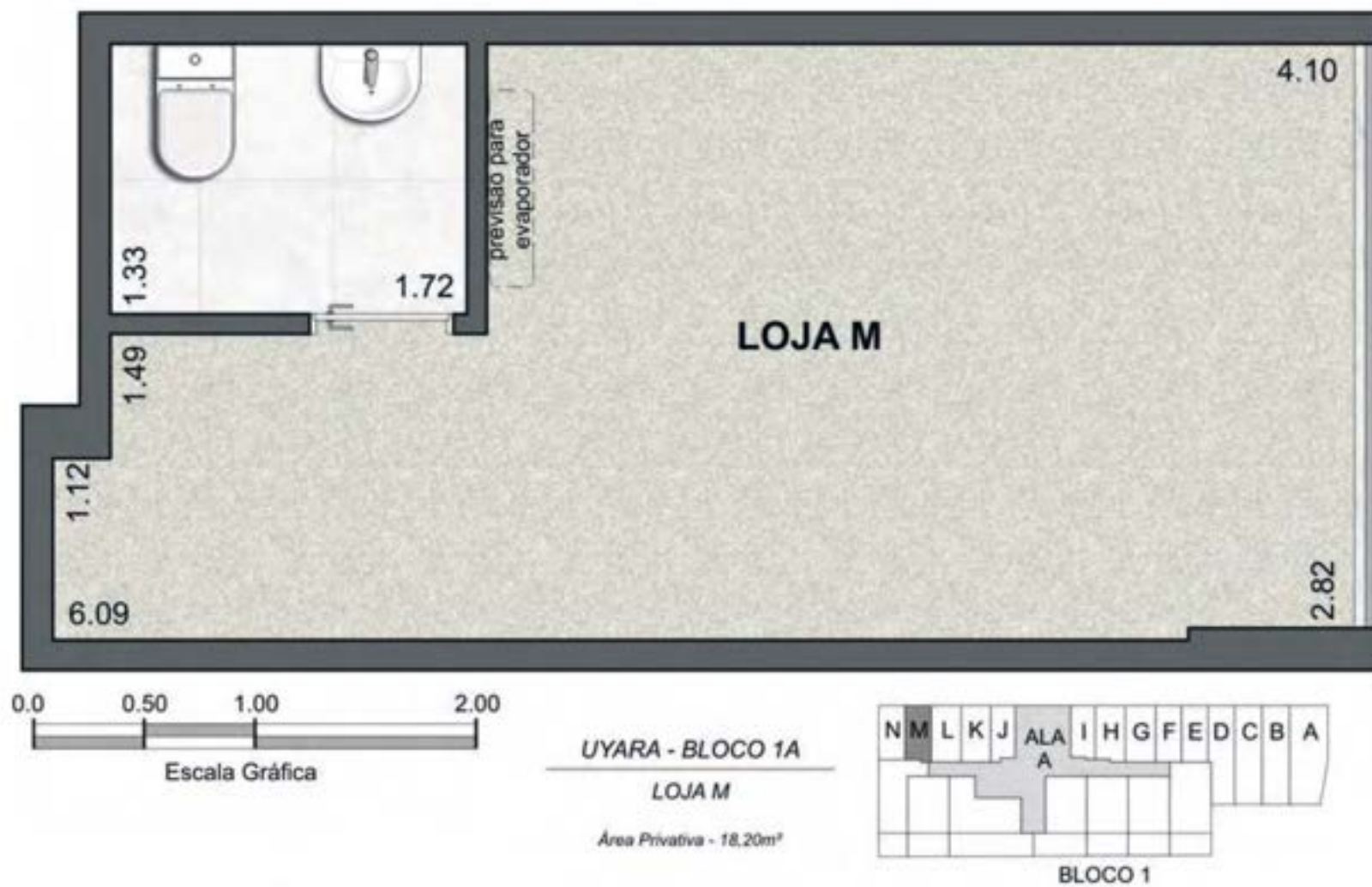

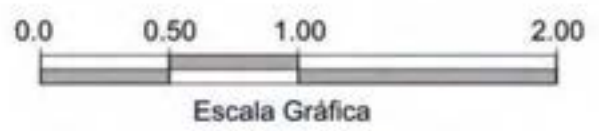
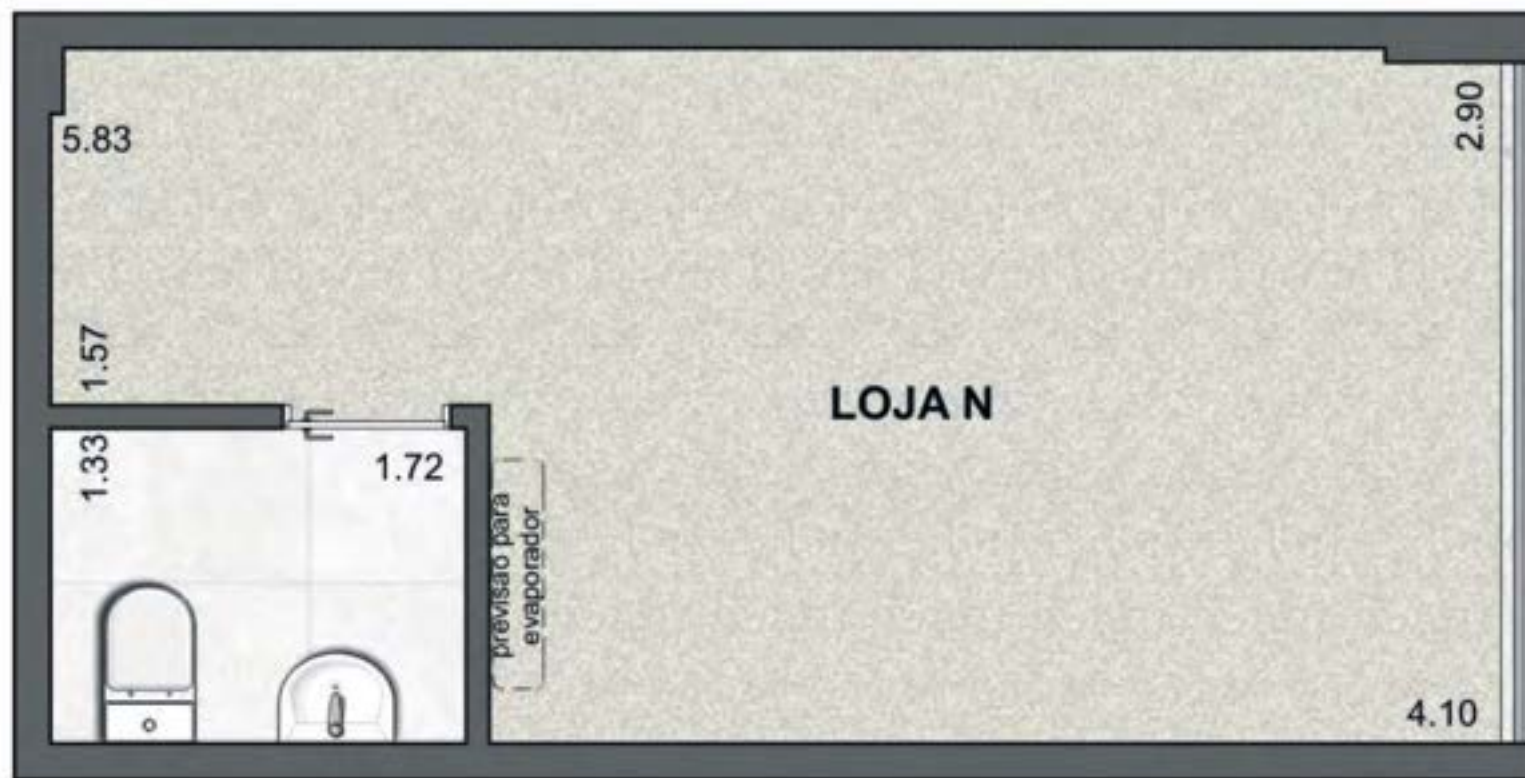

UYARA - BLOCO 1A
LOJA N
Área Privativa - 17,63m²

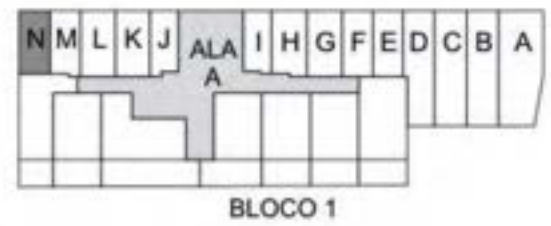

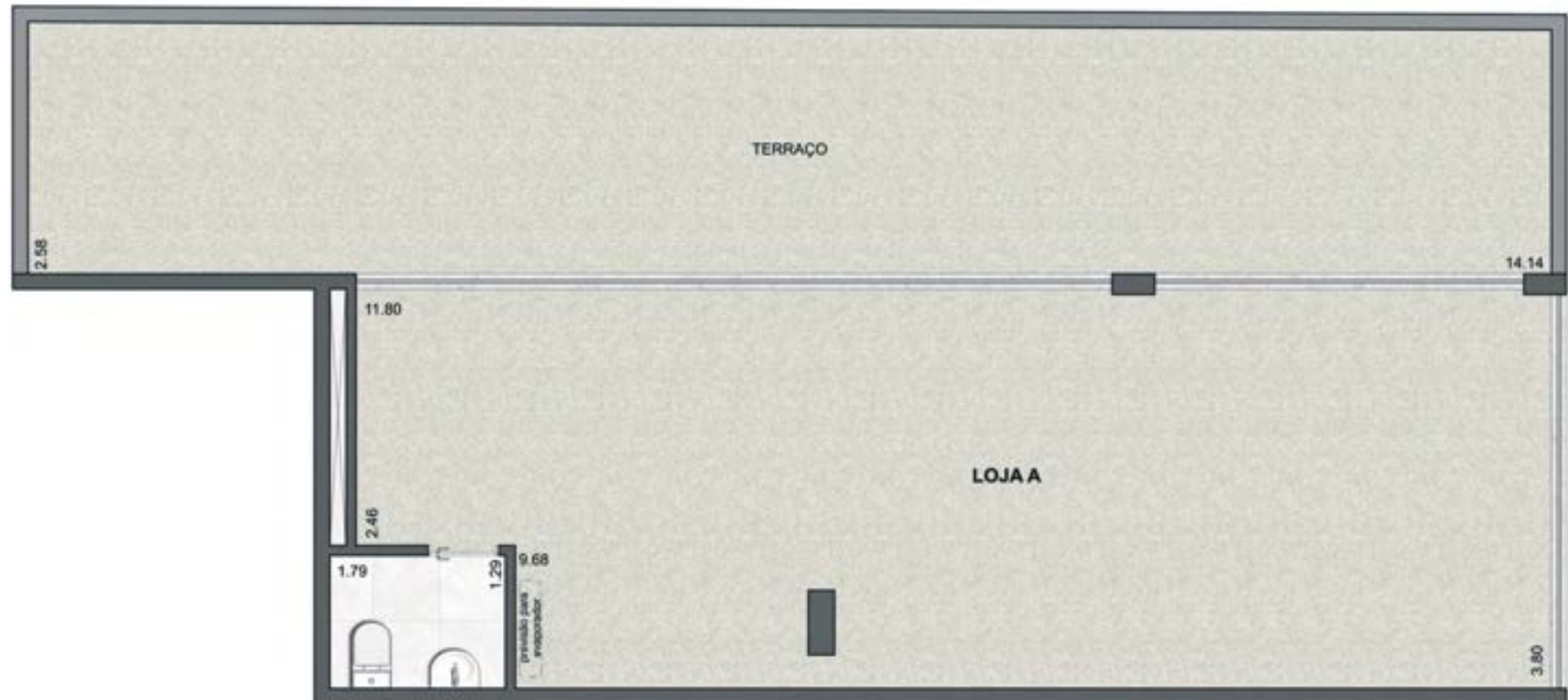

MAYA - BLOCO 2A
 LOJA A
 Área Privativa Total
 45,24m² (loja) + 35,56m² (terraço) - 80,80m²

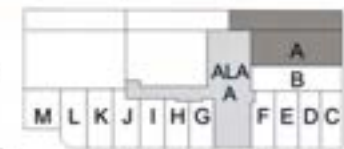

BLOCO 2



0.0 0.50 1.00 2.00
Escala Gráfica

MAYA - BLOCO 2A
LOJA A - SUJESTÃO DECORAÇÃO RESTAURANTE

Área Positiva Total
45,24m² (loja) + 35,56m² (terraço) = 80,80m²

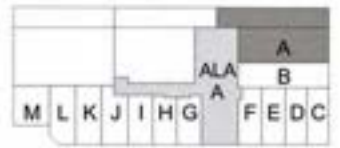

BLOCO 2



MAYA - BLOCO 2A

LOJA B

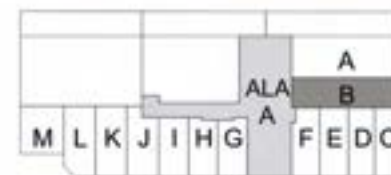
Área Privativa - 44,37m²

BLOCO 2

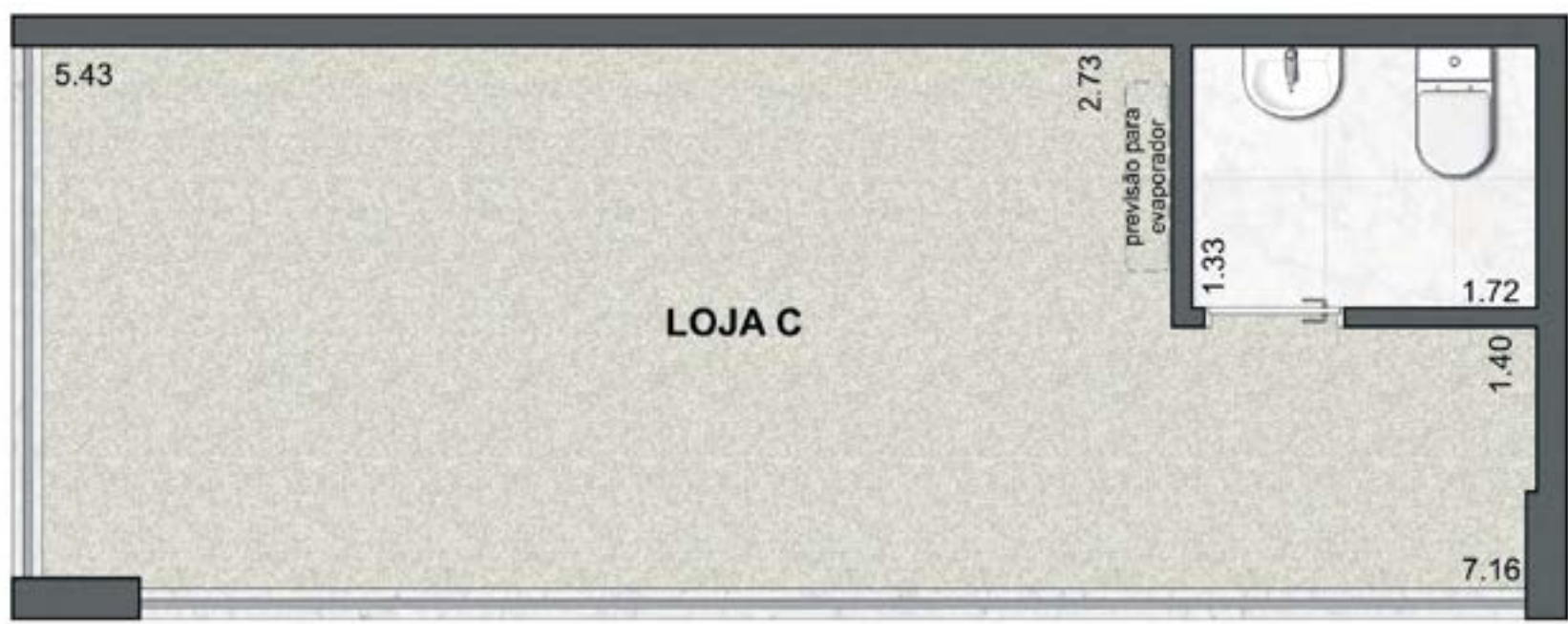

MAYA - BLOCO 2A
LOJA C
Área Privativa - 20,41m²

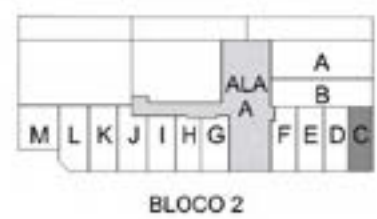

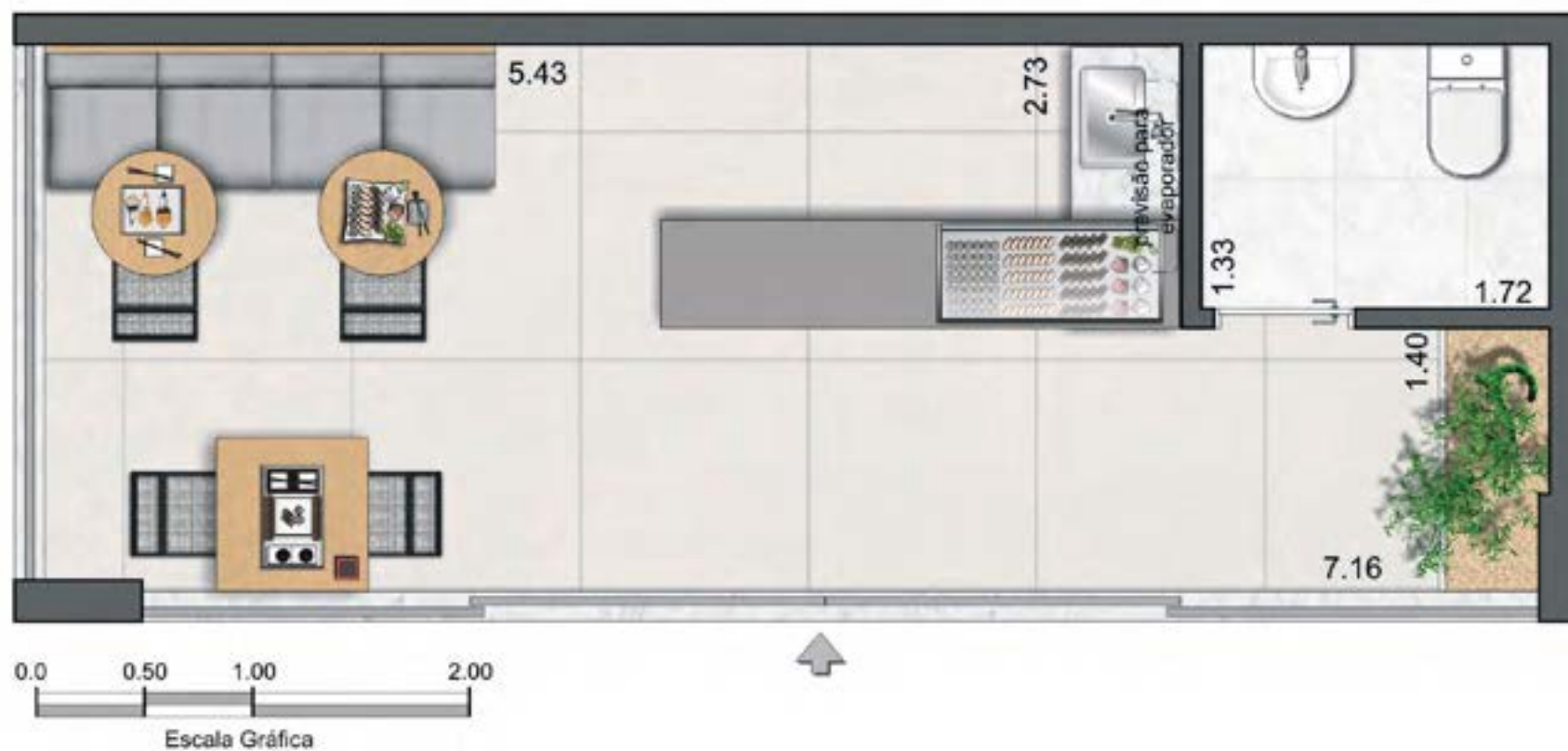

MAYA - BLOCO 2A
 LOJA C - SUGESTÃO DECORAÇÃO
 RESTAURANTE JAPONÊS
 Área Privativa - 20,41m²

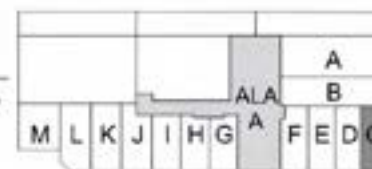

BLOCO 2

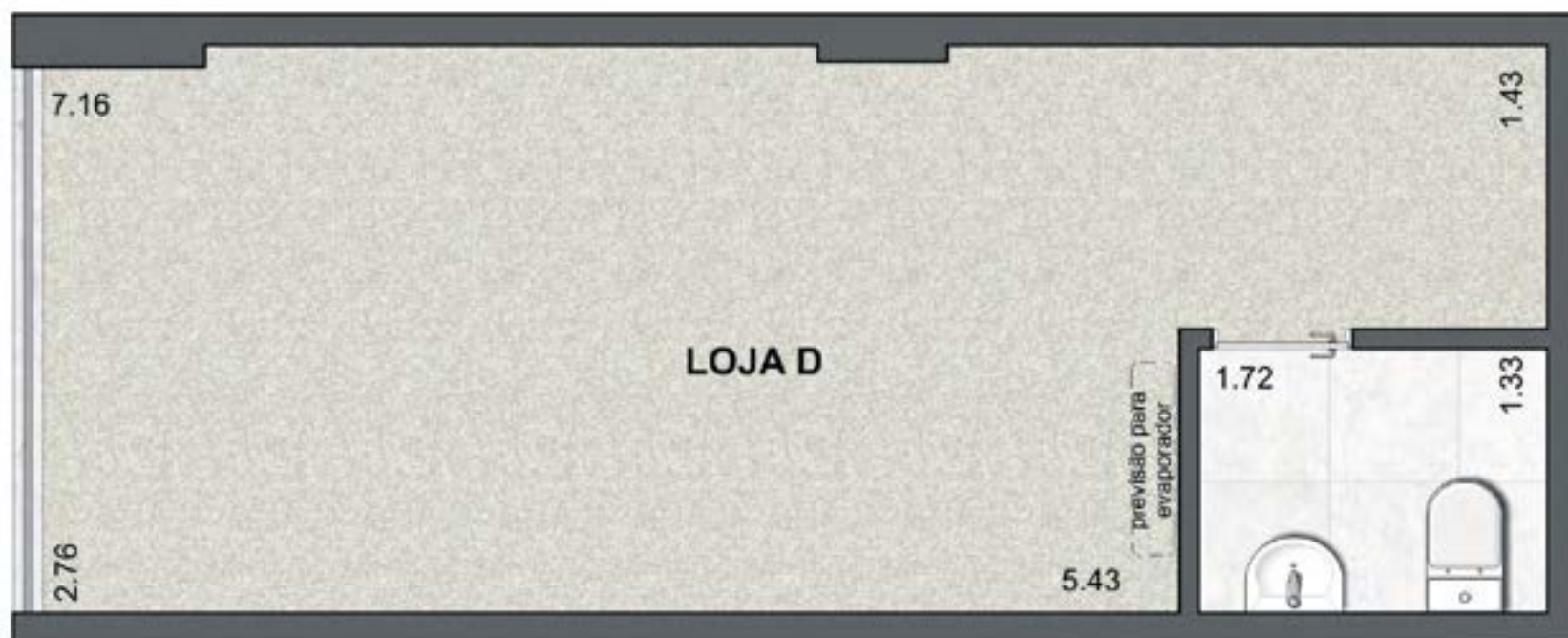

MAYA - BLOCO 2A

LOJA D

Área Privativa - 20,95m²

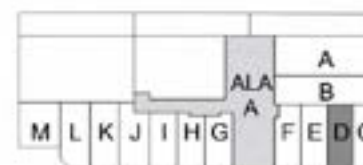

BLOCO 2

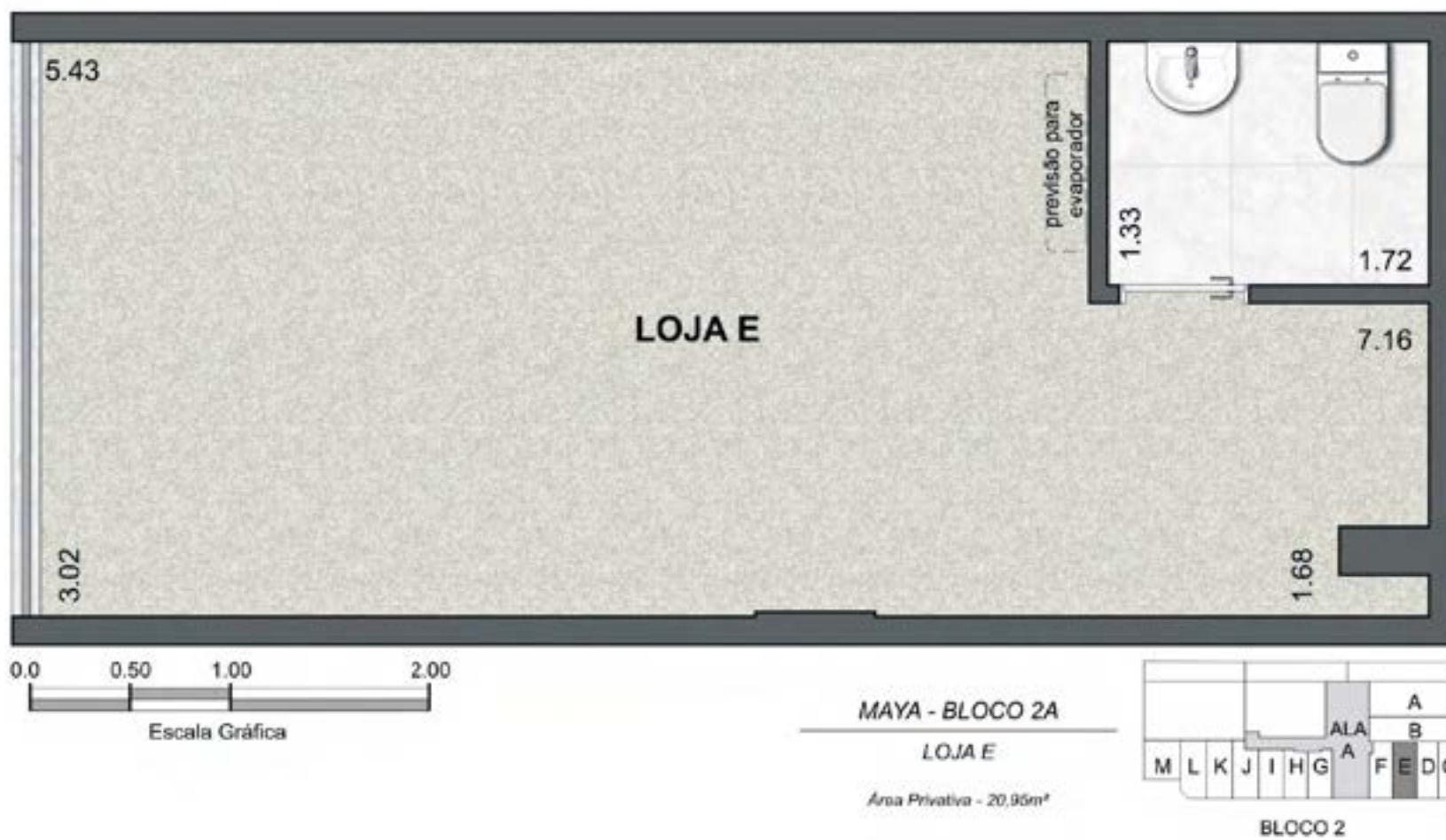

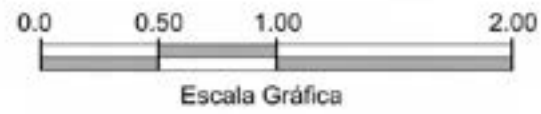

MAYA - BLOCO 2A
LOJA F
Área Privativa - 21,49m²

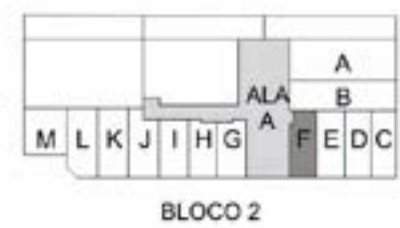

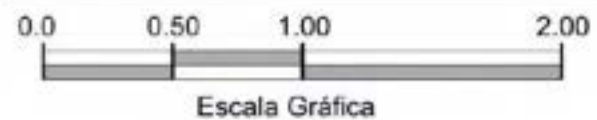
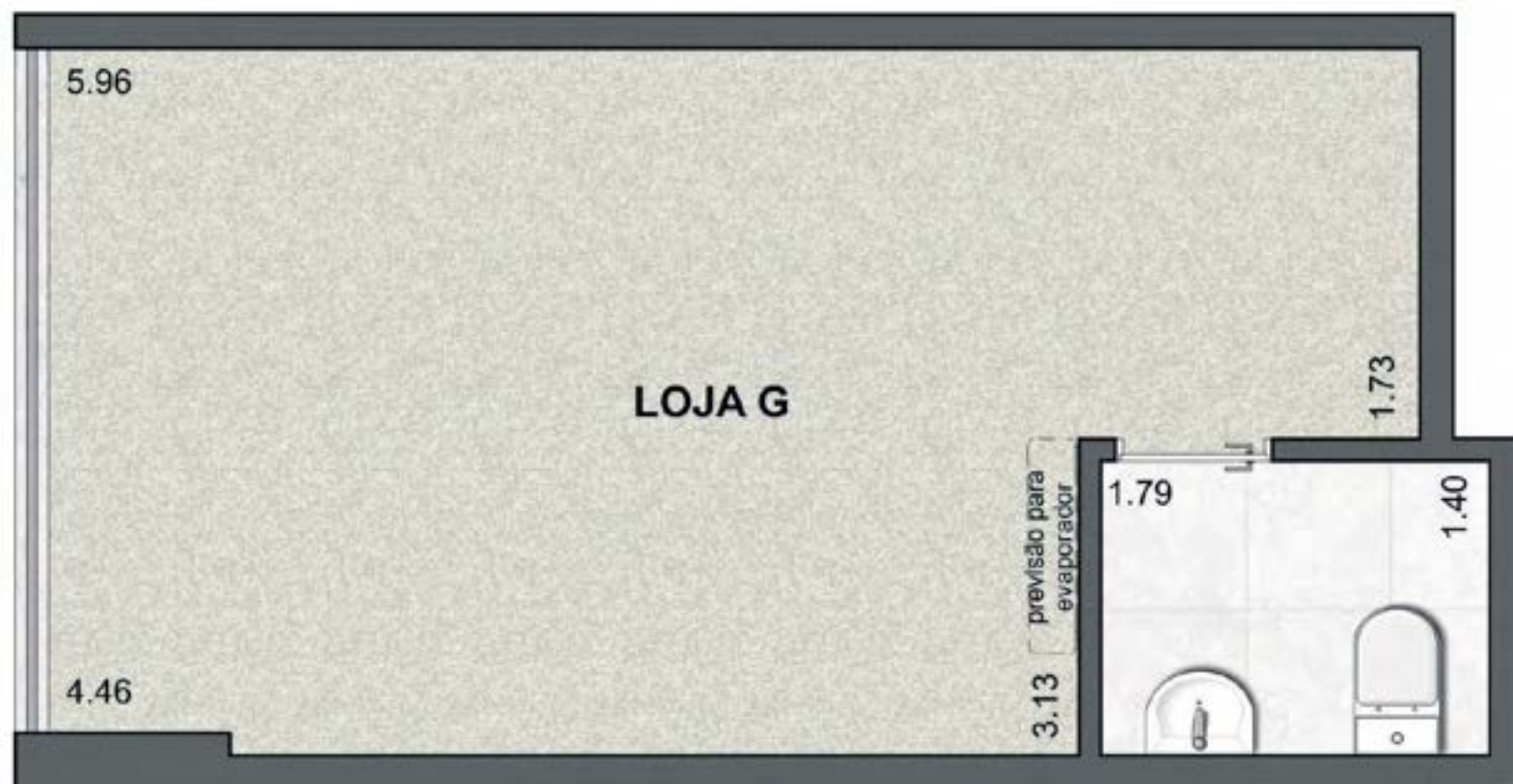

MAYA - BLOCO 2A

LOJA G

Área Privativa - 19,84m²

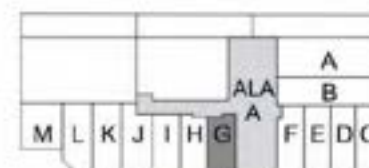

BLOCO 2

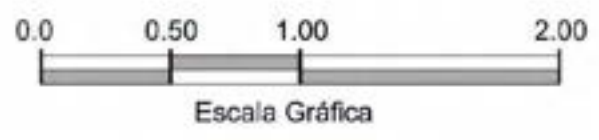
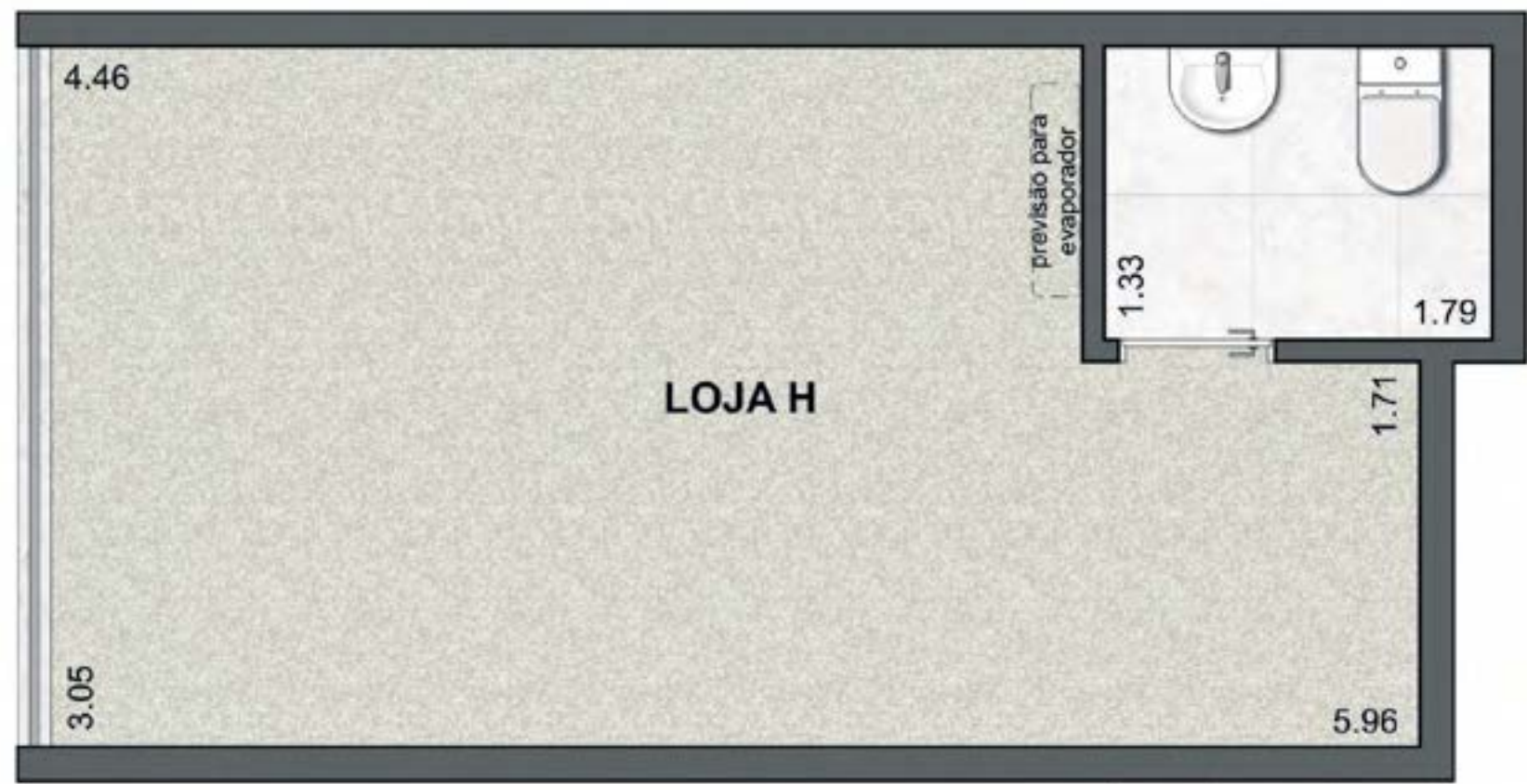

MAYA - BLOCO 2A
LOJA H
Área Privativa - 19,37m²

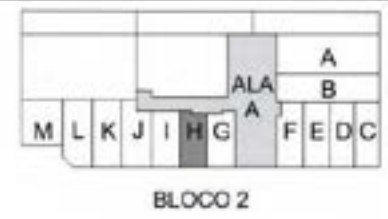

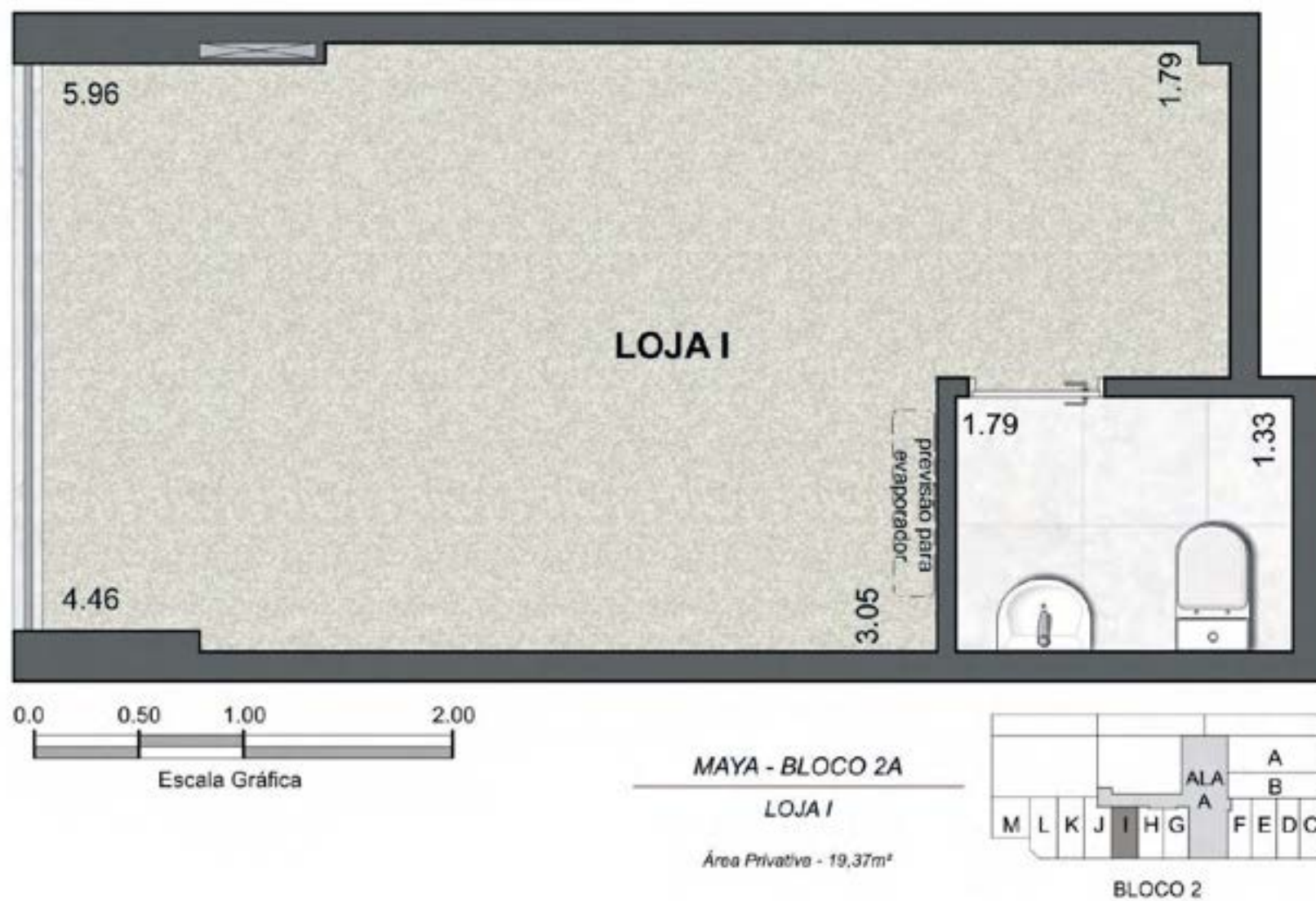

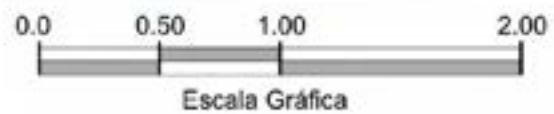
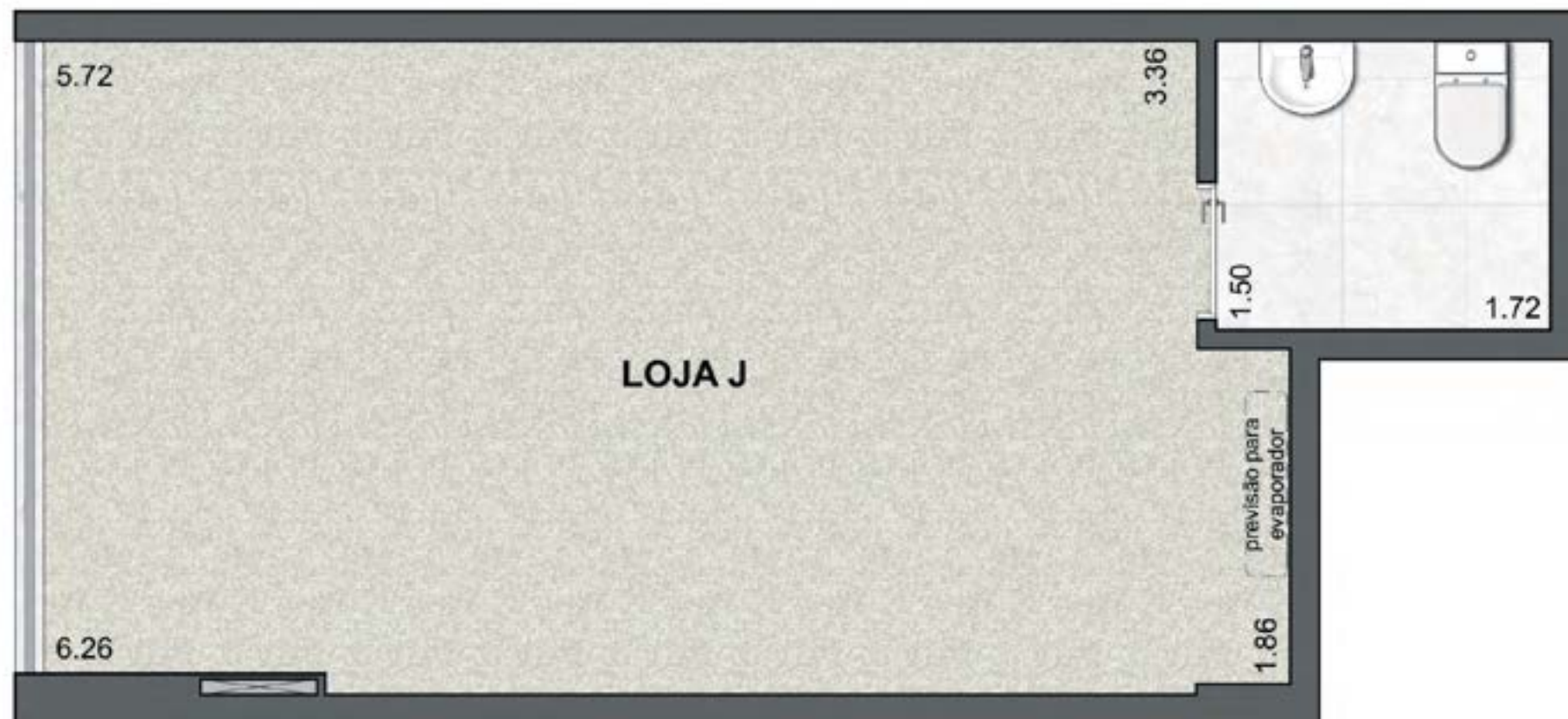

MAYA - BLOCO 2A
LOJA J
Área Privativa - 22,98m²

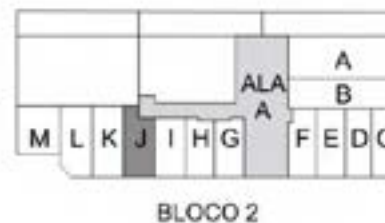

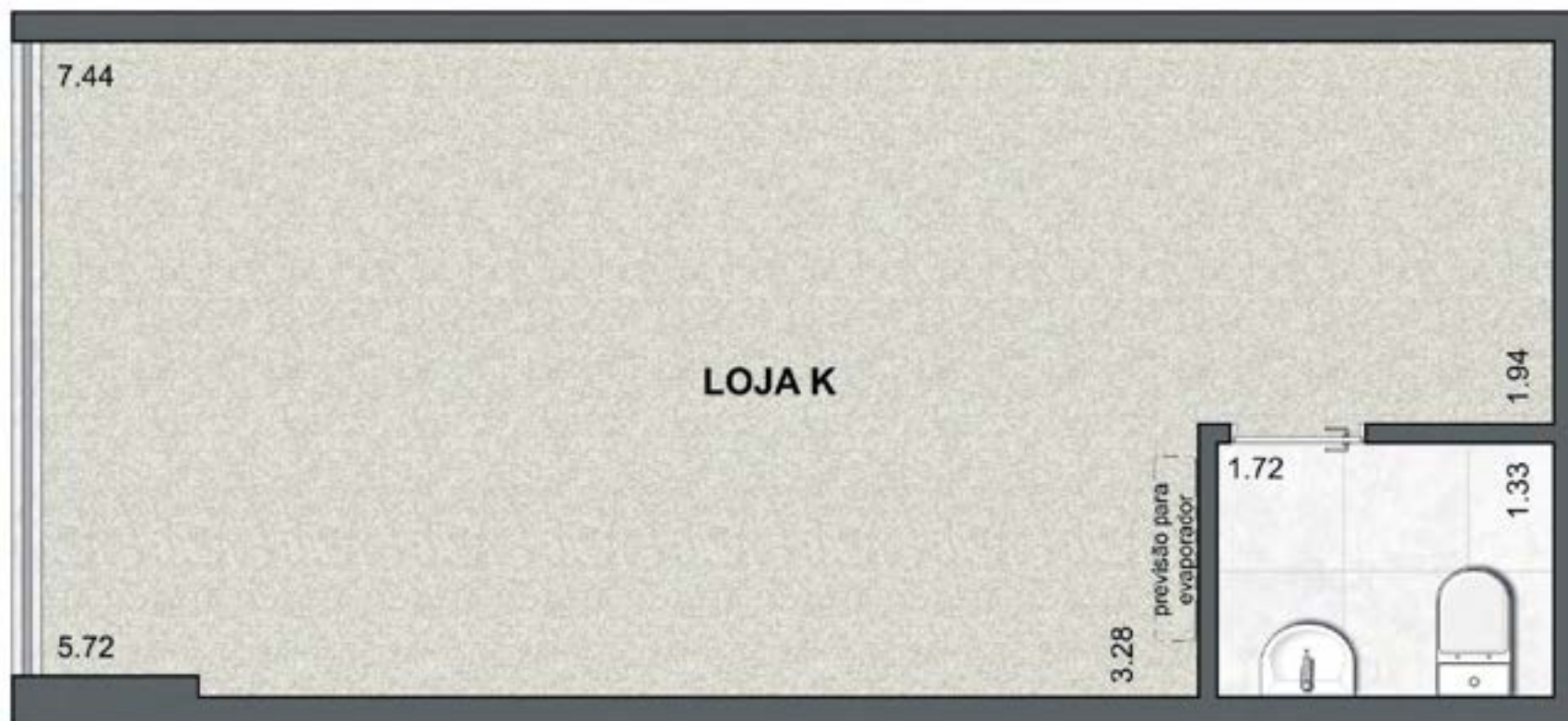

MAYA - BLOCO 2A

LOJA K

Área Privativa - 24,83m²

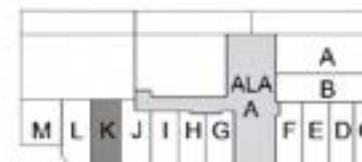

BLOCO 2



MAYA - BLOCO 2A
LOJA L
Área Privativa - 24,52m²

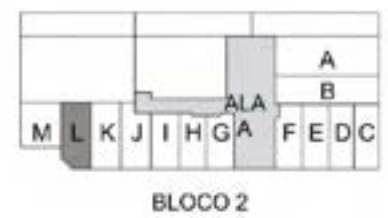



MAYA - BLOCO 2A
 LOJA L - SUGESTÃO DECORAÇÃO
 BEAUTY HAIR

Área Privativa - 24,52m²

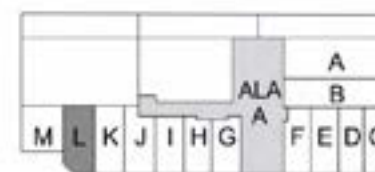

BLOCO 2

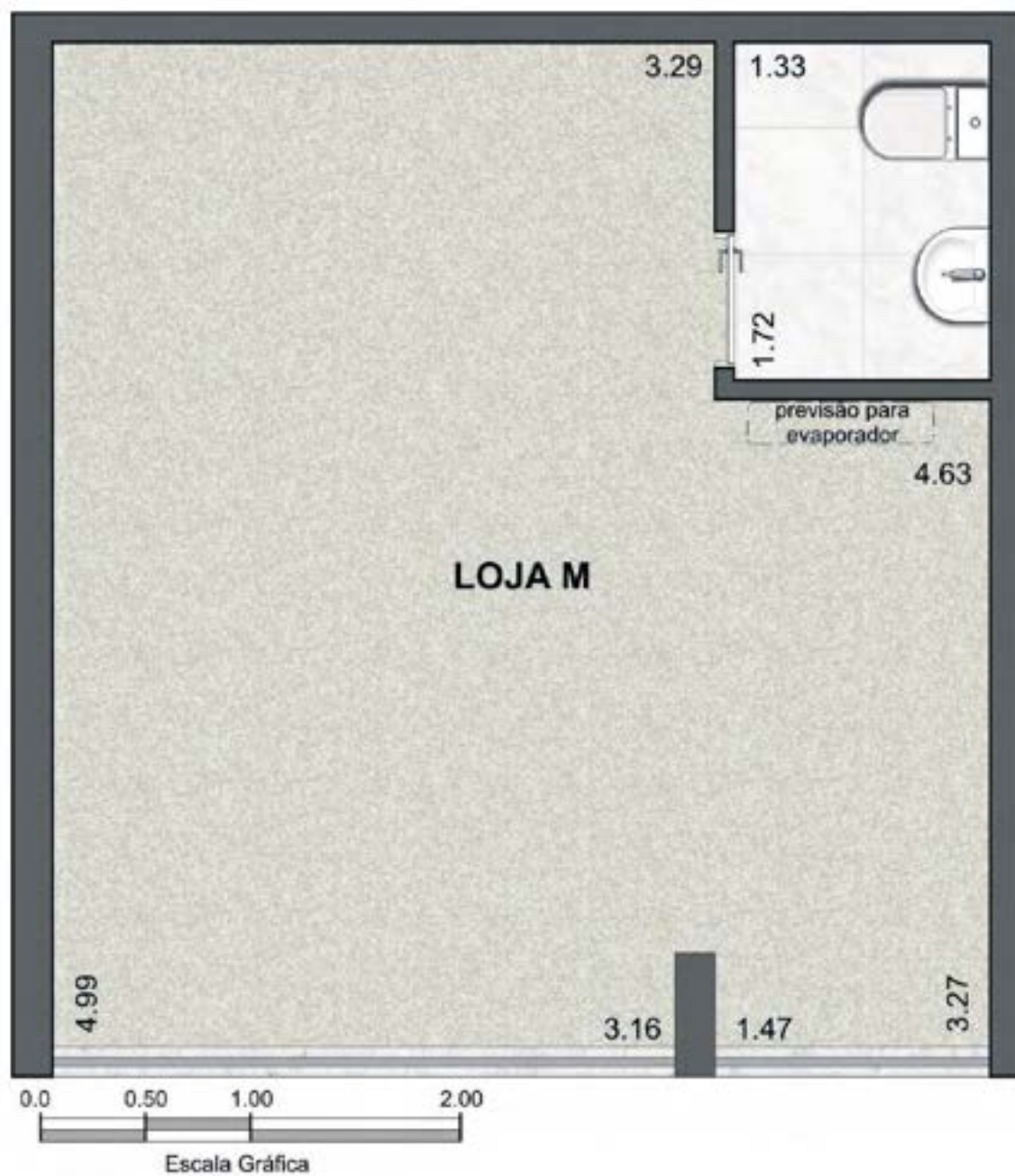



MAYA - BLOCO 2A

LOJA M - SUGESTÃO DECORAÇÃO FARMÁCIA

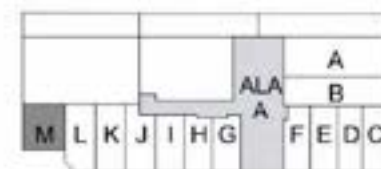
Área Privativa - 23,47m²

BLOCO 2



Planta referente a unidade 102 do bloco 1A.

As demais unidades podem apresentar pequenas variações de medidas que não alteram o layout.



Muro h=2.25m

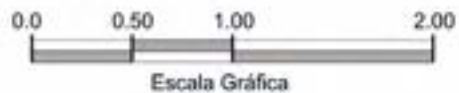

UYARA - BLOCO 1A
APARTAMENTOS 102 E 106

Área Privativa Apto 102
27,70m² (apto) + 11,12m² (terraço) = 38,82m²

Área Privativa Apto 106
27,81m² (apto) + 11,12m² (terraço) = 38,93m²

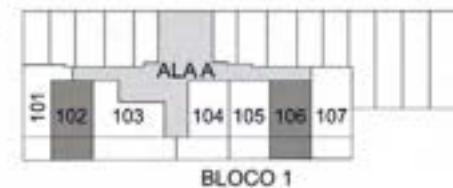



Muro h=2.25m





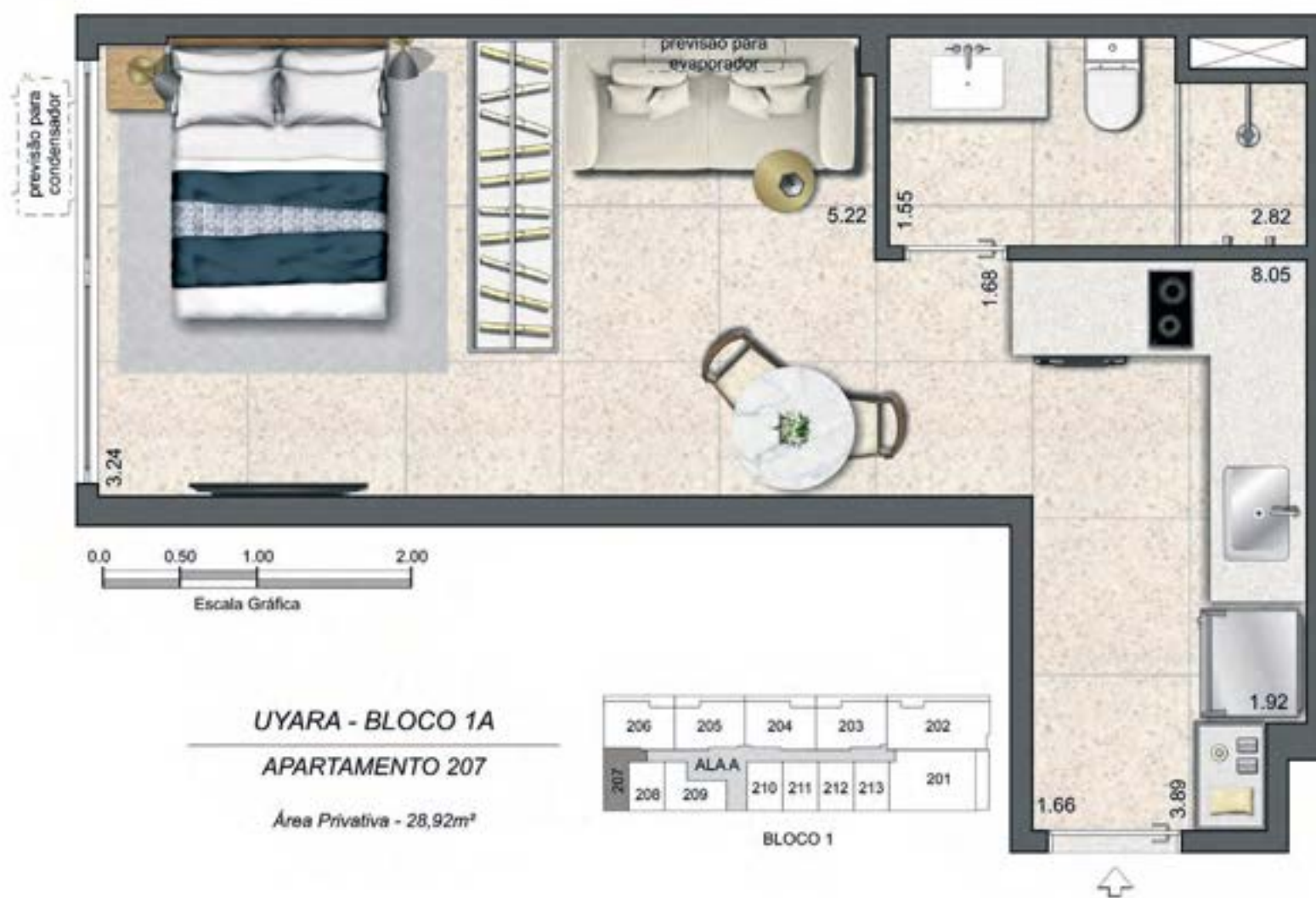



UYARA - BLOCO 1A
APARTAMENTOS 208, 210 E 212

Área Privativa
Apto 208 - 27,70m²
Apto 210 - 28,59m²
Apto 212 - 27,81m²

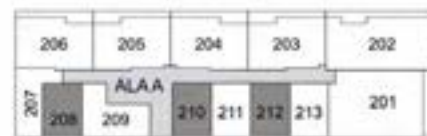

BLOCO 1



UYARA - BLOCO 1A

APARTAMENTOS 211 E 213

Área Privativa - 27,81m²

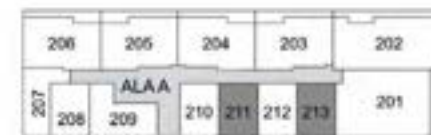

BLOCO 1

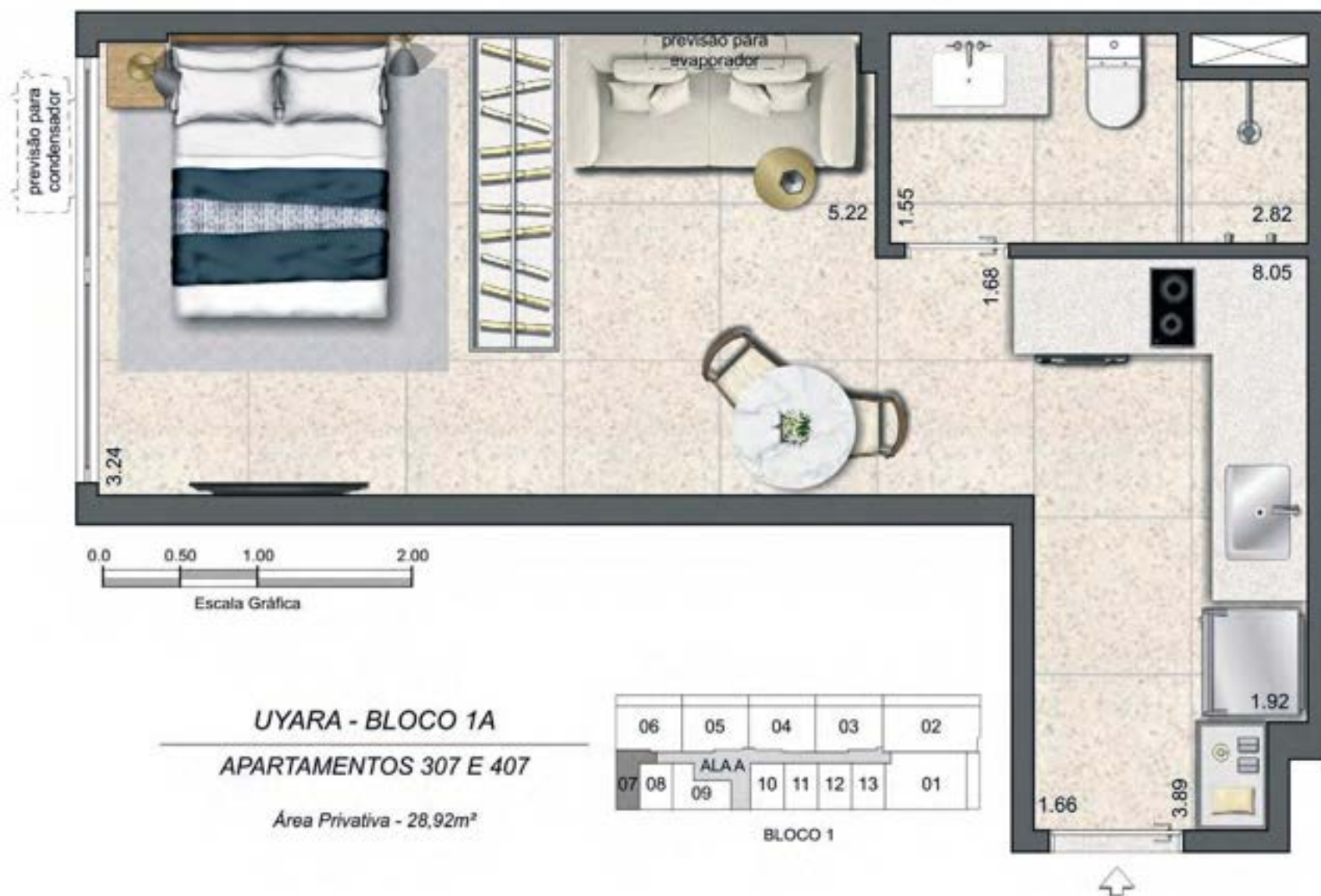



UYARA - BLOCO 1A
APARTAMENTOS 311, 313, 411 E 413

Área Privativa - 27,81m²

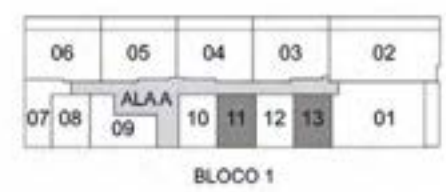



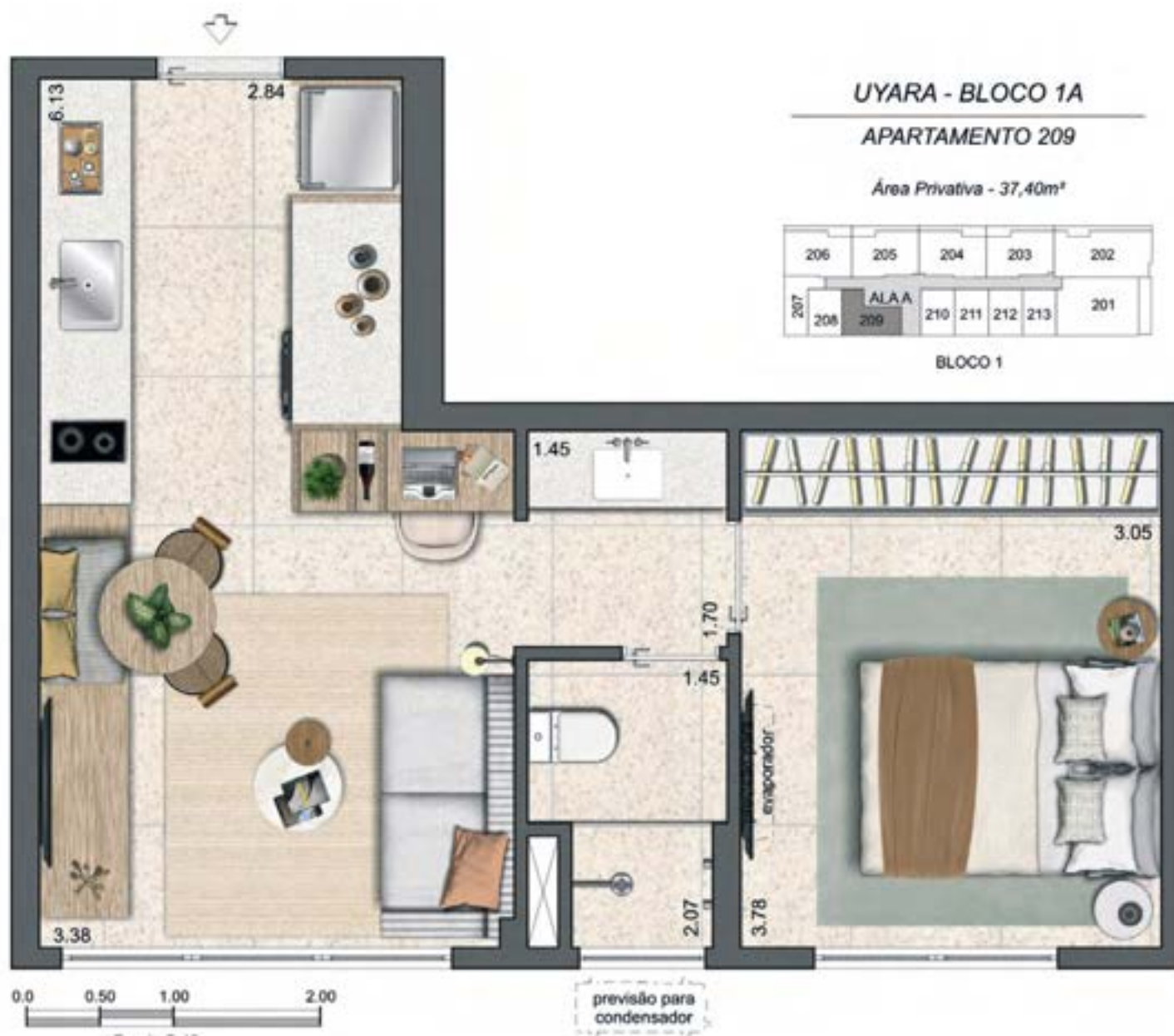

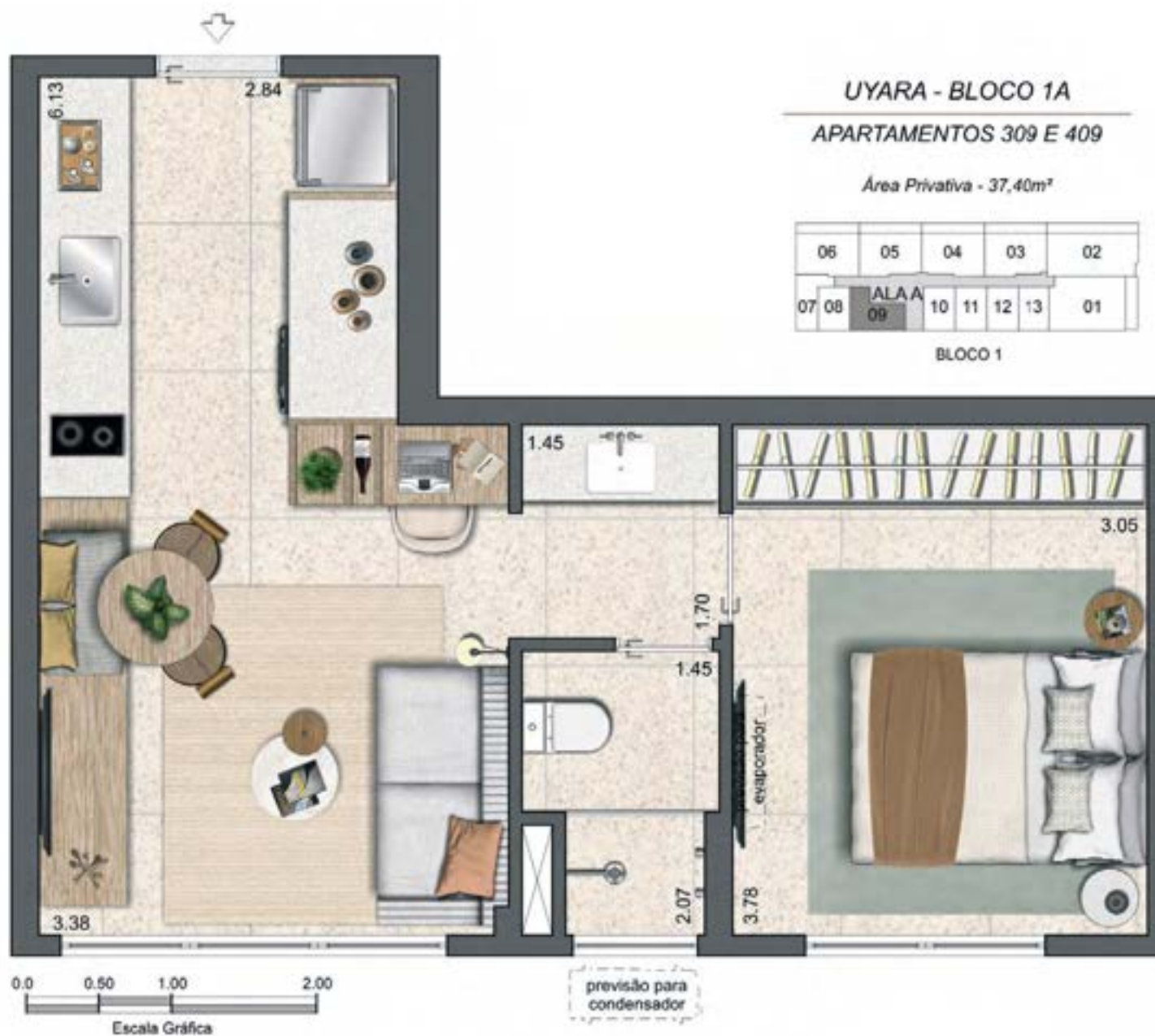

• 2 QUARTOS GOURMET •









UYARA - BLOCO 1A

APARTAMENTO 206

Área Privativa
 $52,34m^2$ (apto) + $9,41m^2$ (varanda) = $61,75m^2$

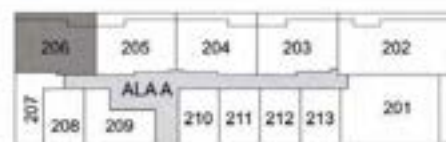

BLOCO 1



UYARA - BLOCO 1A

APARTAMENTOS 303, 305, 403 E 405

Área Privativa
 54,49m² (apto) + 13,80m² (varanda) = 68,29m²

06	05	04	03	02
07	08	09	10	11
		ALAA	12	13
				01

BLOCO 1



UYARA - BLOCO 1A
APARTAMENTO 304

Área Privativa
54,49m² (apto) + 13,80m² (varanda) = 68,29m²

06	05	04	03	02
07	08	09	10	11
			12	13
				01

BLOCO 1



UYARA - BLOCO 1A
APARTAMENTOS 306 E 406

Área Privativa
 54,57m² (apto) + 13,91m² (varanda) = 68,48m²

06	05	04	03	02
07	08	ALA A 09	10	11
			12	13
				01

BLOCO 1



0.0 0.50 1.00 2.00
Escala Gráfica

UYARA - BLOCO 1A
APARTAMENTO 201

Área Privativa
84,02m² (apto) + 13,91m² (varanda) = 97,93m²

	208	205	204	203	202
		ALAA			
201	208	209	210	211	212
			213		201

BLOCO 1



UYARA - BLOCO 1A
APARTAMENTOS 301 E 401

Área Privativa
84,02m² (apto) + 13,91m² (varanda) = 97,93m²

06	05	04	03	02
07	08	ALAA	10	11
		09	12	13
				01

BLOCO 1



UYARA - BLOCO 1A

APARTAMENTOS 302 E 402

Área Privativa
 81,58m² (apto) + 17,67m² (varanda) = 99,25m²

06	05	04	03	02
07	08	09	10	11
ALAA				
			12	13
				01

BLOCO 1



AMANA - BLOCO 1B

APARTAMENTO 102

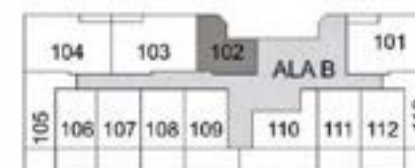
Área Privativa - 30,56m²

BLOCO 1



Planta referente a unidade 106 do bloco 1B.
As demais unidades podem apresentar pequenas variações de medidas que não alteram o layout.



Muro h=2,25m



AMANA - BLOCO 1B

APARTAMENTOS 106, 108 E 111

Área Privativa Apto 106
27,70m² (apto) + 11,12m² (terraço) = 38,82m²

Área Privativa Apto 108
27,81m² (apto) + 11,12m² (terraço) = 38,93m²

Área Privativa Apto 111
27,81m² (apto) + 11,12m² (terraço) = 38,93m²

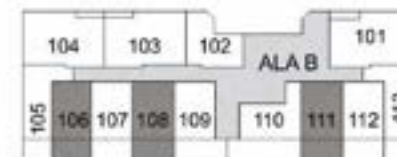

BLOCO 1



AMANA - BLOCO 1B

APARTAMENTOS 107 E 112

Área Privativa Apto 107
 $27,81m^2$ (apto) + $11,12m^2$ (terraço) = $38,93m^2$

Área Privativa Apto 112
 $27,70m^2$ (apto) + $11,12m^2$ (terraço) = $38,82m^2$

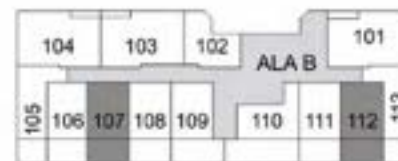

BLOCO 1



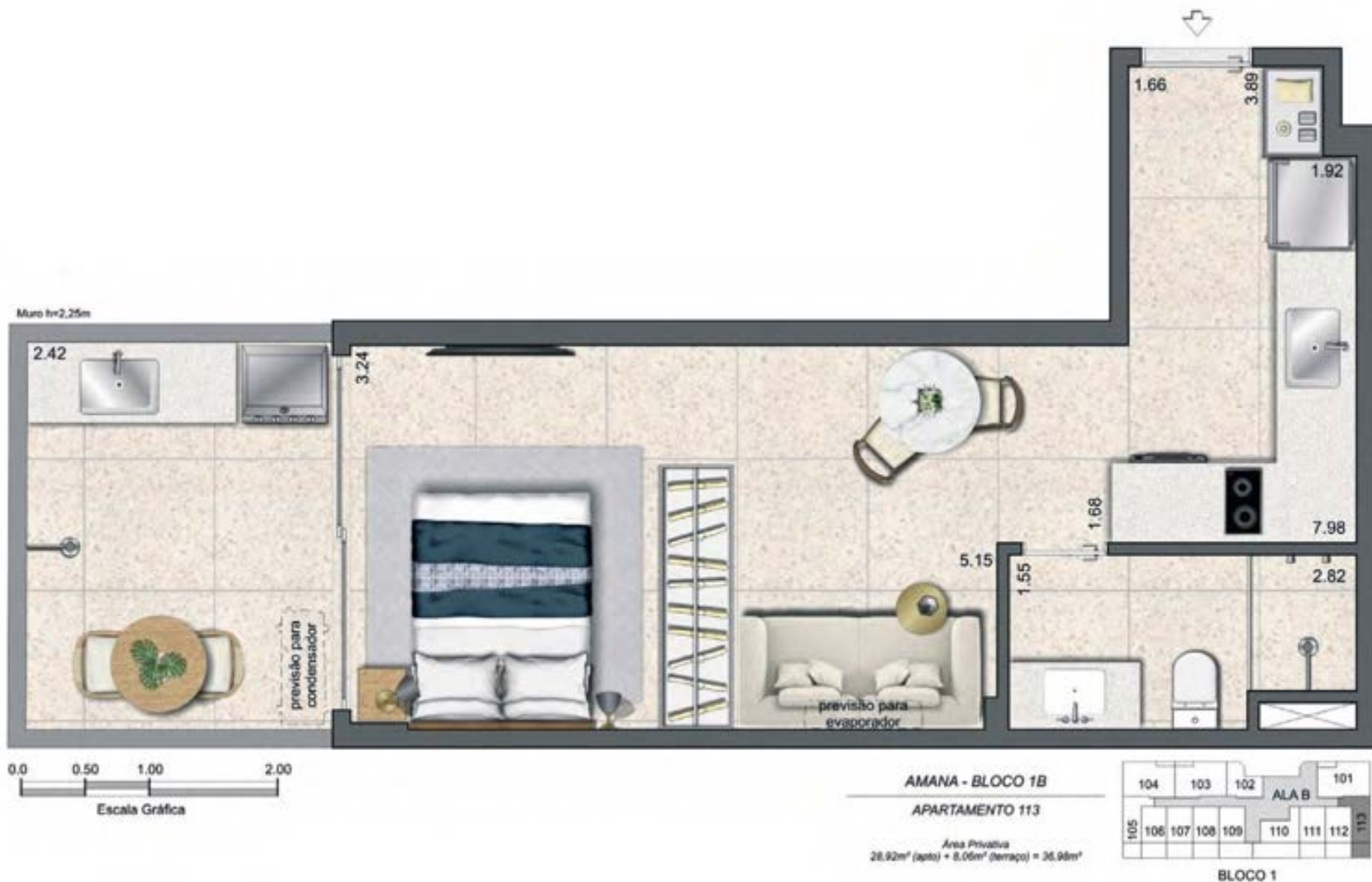

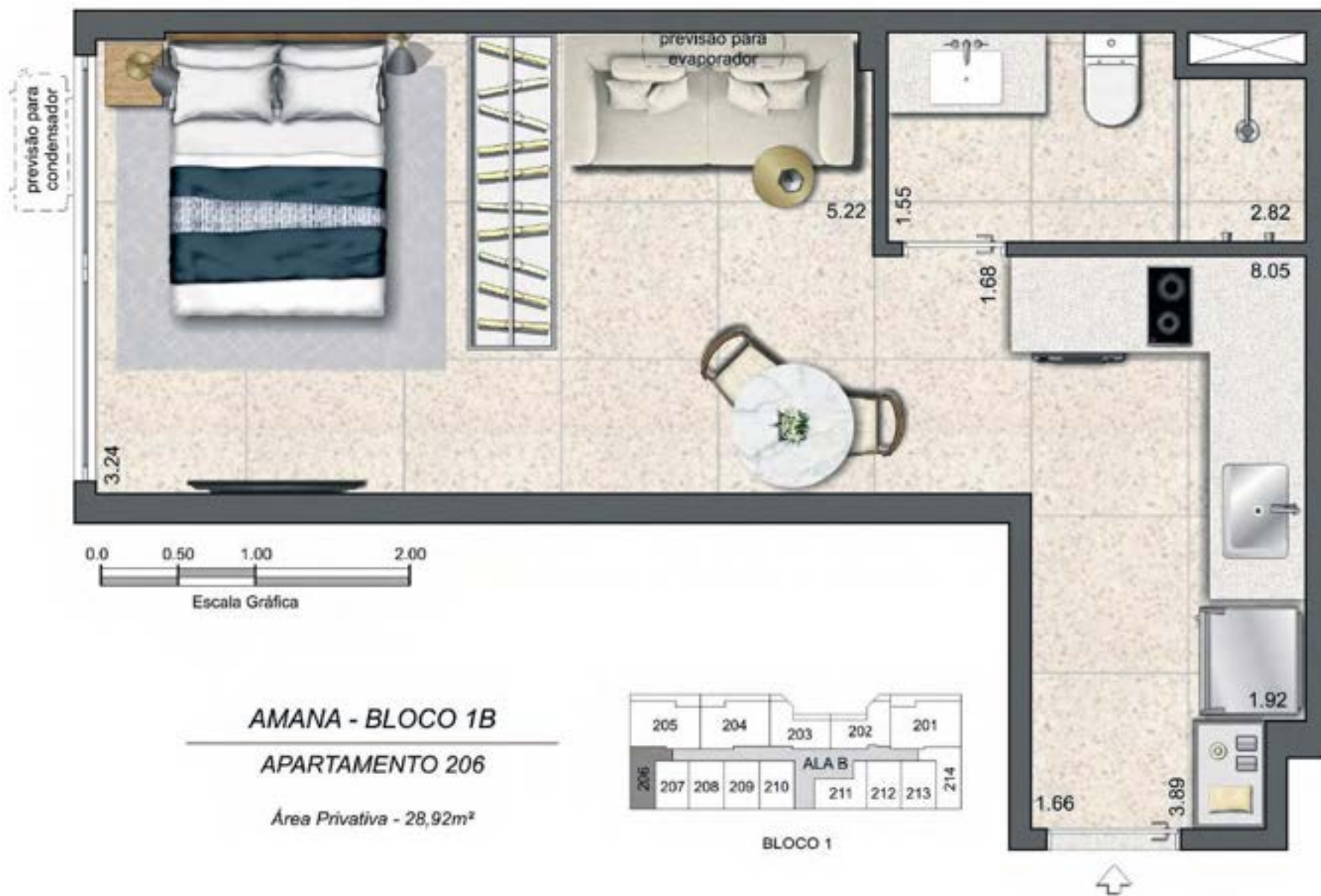



Apartamento referente a unidade 207 do bloco 1B.
As demais unidades podem apresentar pequenas variações de medidas que não alteram o layout.

AMANA - BLOCO 1B
APARTAMENTOS 207, 209 E 212

- Área Privativa
 Apto 207 - 27,70m²
 Apto 209 - 27,81m²
 Apto 212 - 27,81m²

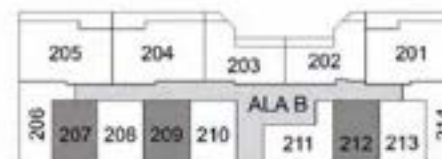

BLOCO 1

Apartamento referente a unidade 208 do bloco 1B.
As demais unidades podem apresentar pequenas variações de medidas que não alteram o layout.



AMANA - BLOCO 1B
APARTAMENTOS 208, 210 E 213

Área Privativa

Apto 208 - 27,81m²

Apto 210 - 28,59m²

Apto 213 - 27,70m²

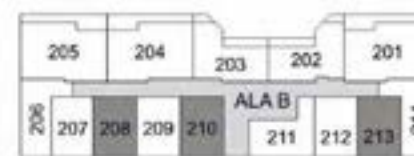

BLOCO 1

AMANA - BLOCO 1B

APARTAMENTO 214

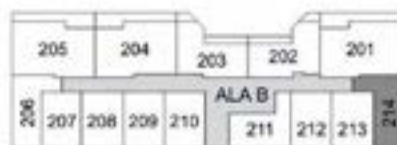
Área Privativa - 28,92m²

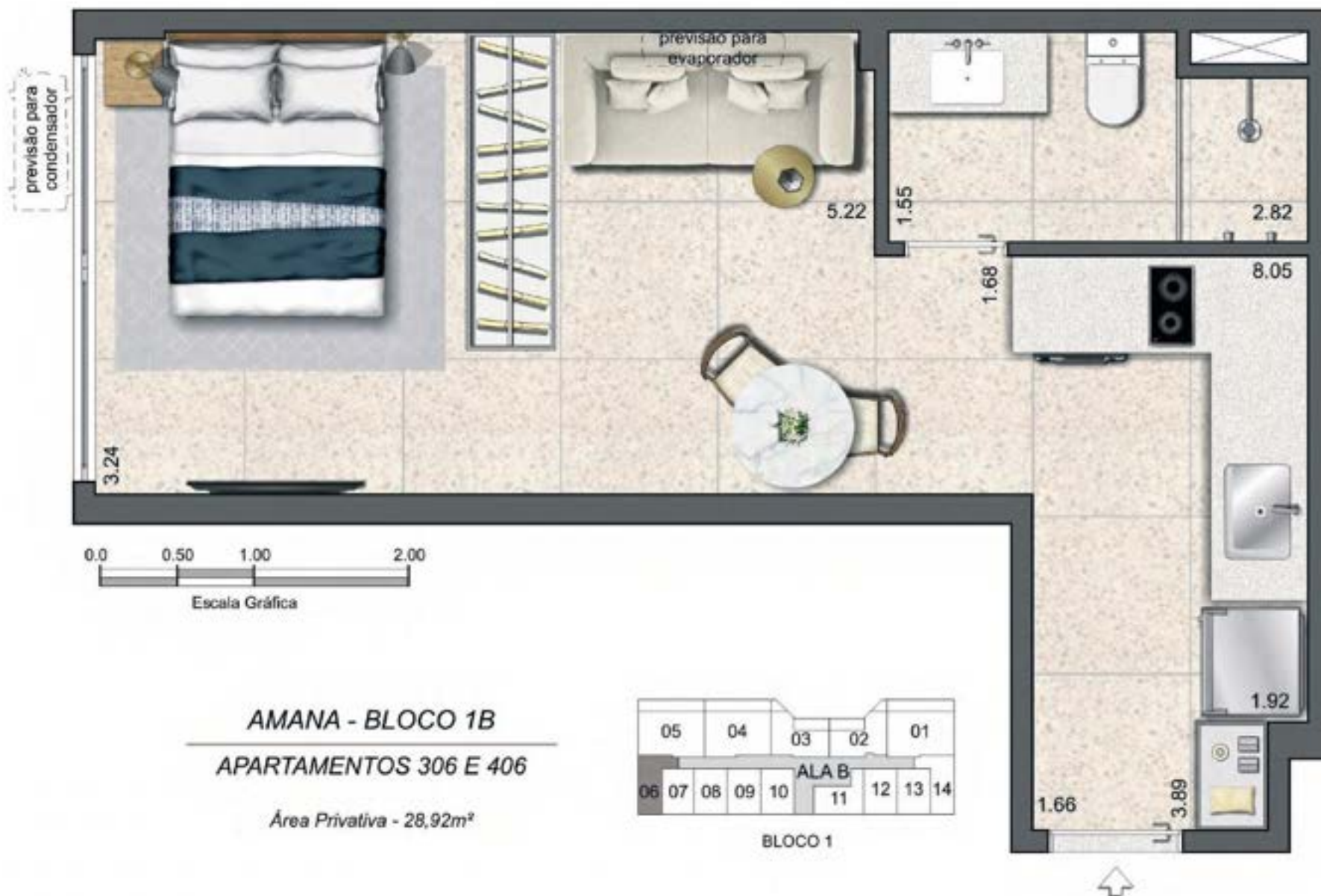

AMANA - BLOCO 1B
APARTAMENTOS 306 E 406

Área Privativa - 28,92m²

Apartamento referente a coluna 08 do bloco 1B.
As demais unidades podem apresentar pequenas variações de medidas que não alteram o layout.



AMANA - BLOCO 1B

APARTAMENTOS 308, 310, 313, 408, 410 E 413

Área Privativa

Aptos 308 / 408 - 27,81m²

Aptos 310 / 410 - 28,58m²

Aptos 313 / 413 - 27,70m²

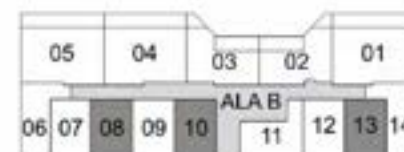

BLOCO 1

AMANA - BLOCO 1B
 APARTAMENTOS 314 E 414

Área Privativa - 28,92m²

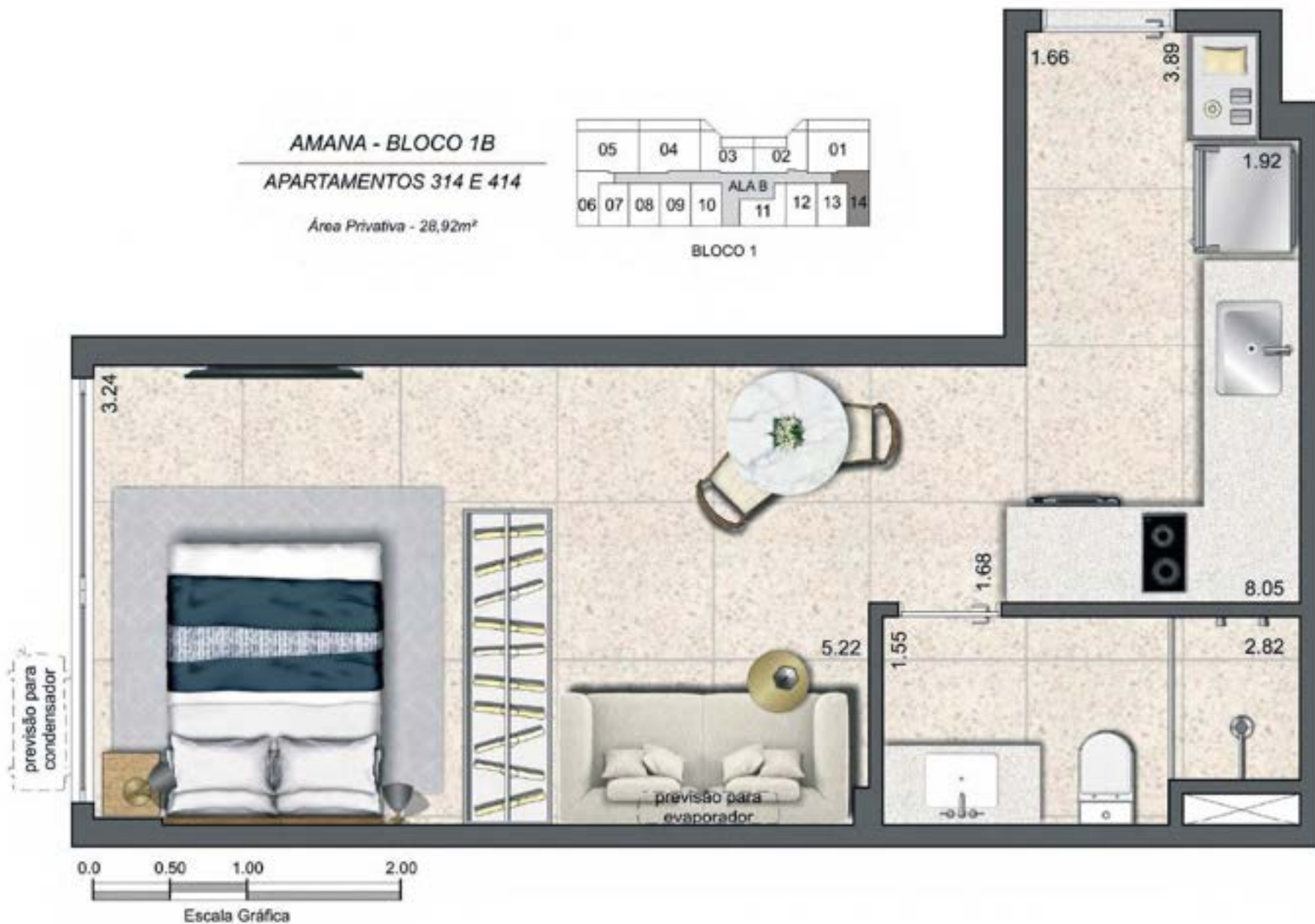
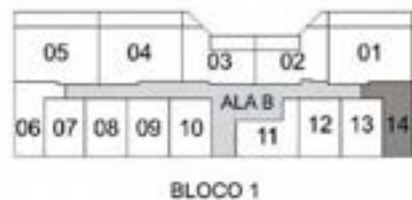

1 QUARTO





AMANA - BLOCO 1B

APARTAMENTO 202

Área Privativa
 $36,23\text{m}^2$ (apto) + $5,24\text{m}^2$ (varanda) = $41,47\text{m}^2$

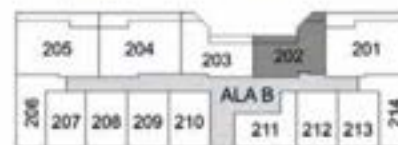

BLOCO 1



AMANA - BLOCO 1B

APARTAMENTO 203

Área Privativa
 $36,23\text{m}^2$ (apto) + $5,24\text{m}^2$ (varanda) = $41,47\text{m}^2$

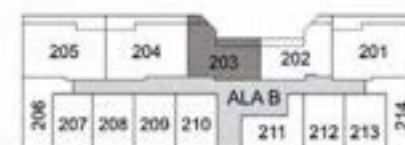

BLOCO 1



AMANA - BLOCO 1B

APARTAMENTO 211

Área Privativa - 30,53m²

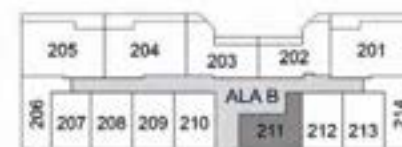

BLOCO 1

1 QUARTO



AMANA - BLOCO 1B

APARTAMENTOS 302 E 402

Área Privativa

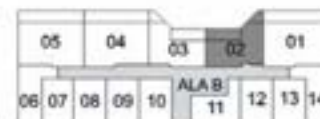
36,23m² (apto) + 9,57m² (varanda) = 45,80m²

BLOCO 1



AMANA - BLOCO 1B
APARTAMENTOS 303 E 403

Área Privativa
 36,23m² (apto) + 9,57m² (varanda) = 45,80m²

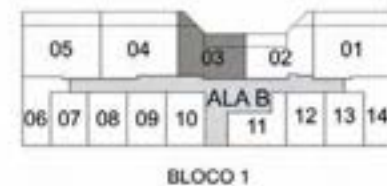



AMANA - BLOCO 1B
APARTAMENTOS 311 E 411
 Área Privativa - 30,53m²

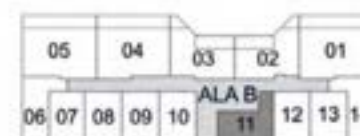

BLOCO 1

• 2 QUARTOS GOURMET •



2 QUARTOS GOURMET

Apartamento referente a unidade 101 do bloco 1B.
As demais unidades podem apresentar pequenas variações de medidas que não alteram o layout.





AMANA - BLOCO 1B

APARTAMENTO 104

Área Privativa
 52.34m^2 (apto) + 2.23m^2 (varanda) = 54.57m^2

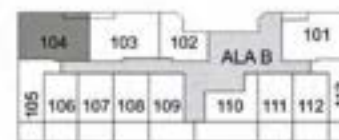

BLOCO 1

Apartamento referente a unidade 201do bloco 1B.
As demais unidades podem apresentar pequenas variações de medidas que não alteram o layout.



AMANA - BLOCO 1B

APARTAMENTOS 201 E 204

Área Privativa Apto 201
52,34m² (apto) + 9,41m² (varanda) = 61,75m²

Área Privativa Apto 204
52,26m² (apto) + 9,35m² (varanda) = 61,61m²

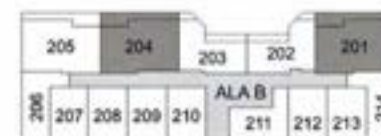

BLOCO 1



AMANA - BLOCO 1B

APARTAMENTO 205

Área Privativa
 $52,34m^2$ (apto) + $9,41m^2$ (varanda) = $61,75m^2$



BLOCO 1

2 QUARTOS GOURMET

Apartamento referente a coluna 01 do bloco 1B.
As demais unidades podem apresentar pequenas variações de medidas que não afetaram o layout.



AMANA - BLOCO 1B

APARTAMENTOS 301, 304, 401 E 404

Área Privativa Apto 301 e 401
54,57m² (apto) + 13,91m² (varanda) = 68,48m²

Área Privativa Apto 304 e 404
54,49m² (apto) + 13,80m² (varanda) = 68,29m²

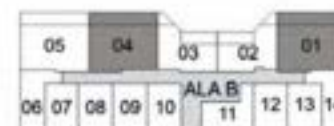

BLOCO 1



AMANA - BLOCO 1B
APARTAMENTOS 305 E 405

Área Privativa
 54,57m² (apto) + 13,91m² (varanda) = 68,48m²

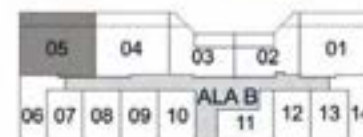

BLOCO 1

• PLANTAS - ARIÊ •



• 1 QUARTO •





• 2 QUARTOS •













ARIÉ - BLOCO 2B

APARTAMENTO 203

Área Privativa
67,85m² (apto) + 9,68m² (varanda) = 77,54m²



BLOCO 2













ARIÉ - BLOCO 2B
APARTAMENTOS 307 E 407

Área Privativa
 66,63m² (apto) + 4,21m² (varanda) = 70,84m²

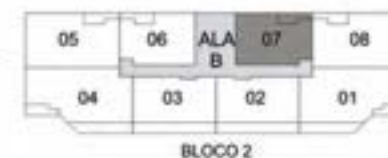

• 3 QUARTOS •





















ITAYBA - BLOCO 2C
 APARTAMENTO 102
 Área Privativa
 37,98m² (apto) + 2,38m² (varanda) = 40,36m²

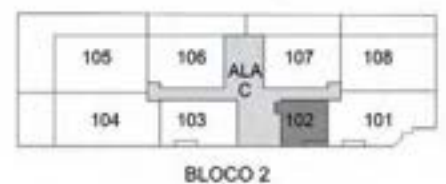

• 2 QUARTOS •









ITAYBA - BLOCO 2C

APARTAMENTO 203

Área Privativa
 $67,66\text{m}^2$ (apto) + $9,68\text{m}^2$ (varanda) = $77,34\text{m}^2$



BLOCO 2

2 QUARTOS





ITAYBA - BLOCO 2C

APARTAMENTO 207

Área Privativa
66,63m² (apto) + 4,21m² (varanda) = 70,84m²





0.0 0.50 1.00 2.00
Escala Gráfica

ITAYBA - BLOCO 2C
APARTAMENTOS 303 E 403

Área Privativa
69,96m² (apto) + 14,69m² (varanda) = 84,65m²

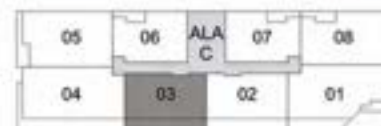

BLOCO 2













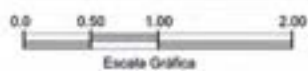

ITAYBA - BLOCO 2C

APARTAMENTO 204

Área Privativa
99,11m² (apto) + 16,64m² (varanda) = 115,75m²



BLOCO 2



ITAYBA - BLOCO 2C
 APARTAMENTO 205
 Área Privativa
 93,63m² (apto) + 9,47m² (varanda) = 103,10m²







ITAYBA - BLOCO 2C
APARTAMENTOS 305 E 405

Área Privativa
93,63m² (apto) + 9,47m² (varanda) = 103,10m²

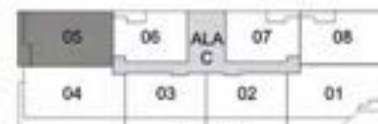

BLOCO 2

